

SPRINGFIELD COMMUNITY PRESERVATION FULL APPLICATION COVER SHEET

I. PROJECT INFORMATION

CPA program area - check all that apply:

community housing
 historic preservation
 open space
 recreation

Project/Program Title: **Spanish American War Memorial Monument**

Brief Project/Program Summary:

The Department of Parks, Buildings and Recreation Management (DPBRM), through this grant opportunity, aims to restore and preserve the Spanish American War Memorial monument located in the Memorial Square neighborhood at the intersection of Main Street, Plainfield Street and Bradford Street. Improvements will include restoration of the bronze and granite monument, improved brick paver walkways and landscape improvements to the surrounding terrace.

estimated start date: November 2020

estimated completion date: November 2021

II. APPLICANT INFORMATION

Type of Applicant - check one:

City of Springfield
 Non-Profit Organization
 For-Profit Business
 Individual

Name of Organization: **Department of Parks, Buildings & Recreation Management**

Name of Contact Person: **Patrick Sullivan**

Mailing Address: **200 Trafton Road**

Mailing City/State/Zip: **Springfield, MA 01108**

Phone: **413-787-7770**

Fax: **413-787-6439**

Email: **PSullivan@springfieldcityhall.com**

Website: **www.springfieldcityhall.com**

III. BUDGET SUMMARY

Estimated Project Budget: **\$150,000**

CPA Funding Request: **\$150,000**

Will you be seeking multi-year funding
 Yes
 No

CPA Request as Percentage of Total Project/Program Budget: **\$150,000**

List Other Secured Funding Sources:

No other funding sources are available at this time.

List Other Prospective Funding Sources:

No other funding sources have been identified at this time.

Applicant Signature: _____

Date Submitted: _____

4/24/2020

I. GENERAL INFORMATION – SPANISH AMERICAN WAR MEMORIAL MONUMNET

Community Preservation Funds are available in four categories. There are some questions that are only relevant to certain categories. Please only answer the questions in this section that relate to the category(s) that are being applied for.

- A. All Categories that involve property (land and/or buildings)
 - 1. Provide the parcel ID number(s) for property included in the project
 - a. Parcel Id: 08130-0212
 - 2. Does the applicant own the property?
 - a. Yes. All city monuments are owned by the City of Springfield and maintained by the Department of Parks, Buildings & Recreation Management (PBRM).
 - 3. If the applicant does not own the property, attach a purchase & sale agreement to purchase the property.
 - a. Not applicable.
- B. Community Housing Questions – Not applicable to this project.
- C. Historic Preservation Questions –
Historic preservation projects must follow the Secretary of Interior Standards for Rehabilitation. Assisted properties will be required to be subject to an exterior preservation restriction or to be placed under local historic district protection.
 - 1. What steps will be taken to ensure the work complies with the Secretary’s Standards?

As the Spanish American War Memorial Monument is located in Memorial Square, a National Historic Register neighborhood, and the monument itself is listed on the State’s Inventory of Historic places, the project will follow the recommended standards as described in the Secretary of the Interior’s Standards for the Treatment of Historic Properties.

The Spanish American War Memorial Monument Rehabilitation project falls under the Building Site Standards of the document:

A property shall be used for its historic purpose, its historic character preserved and its historic significance retained and preserved.

The project aims to restore and preserve the condition of the granite and bronze Spanish American War Memorial Monument, located at the intersection of Plainfield, Main and Bradford Streets in Springfield’s Memorial Square neighborhood, as a means of connecting the public to this open space. Through restoration work on the base, plaques and the statue, the monument and its historic properties will be preserved. The project will also include an evaluation of the monument by a qualified conservationist/historic preservationist to make recommendations for the condition of and treatments for the restoration of the Spanish American War Memorial Monument.

Distinctive features, finishes and construction techniques or examples of craftsmanship that characterize a historic property shall be preserved.

The historic craftsmanship of the bronze work will be honored, with special attention to the bronze soldier statue and remembrance plaques. The stone base and monument will undergo restoration efforts as needed, and the surrounding landscape and walkways will be enhanced.

City of Springfield – Department of Parks, Buildings & Recreation Management
Spanish American War Memorial Monument – CPA 2020 Application

Providing continued protection and maintenance of buildings and landscape features on the site through appropriate grounds or landscape management

The Department of Parks, Buildings and Recreation Management will enhance and maintain the brick paver walkways and landscaping surrounding the Spanish American War Memorial Monument. It is proposed to design and install a plaque that explains and honors the Memorial Square neighborhood as a National Registry of Historic places.

1. What is the age of the property?
 - a. The Spanish American War Memorial Monument was constructed in 1906. The monument is 114 years old.
2. Will the owner agree to a preservation restriction or local historic district designation?
 - a. Yes. The Department of Parks, Buildings & Recreation Management is dedicated to the preservation the City's historical monuments and markers. The Spanish American War Memorial Monument is located the Memorial Square historic district and is listed on the State and National Historic Registers, see attached historical registration information.

D. Open Space & Recreation Questions

1. Is this project in a wetland or does it abut a wetland?
 - a. No, the Spanish American War Memorial Monument is not located in a wetland.
2. If so, has the Conservation Commission been informed?
 - a. Not applicable to this project.
3. If the project is on municipal park or conservation land, attached a letter of support from the Park Commission or Conservation Commission.
 - a. The Spanish American War Memorial Monument is located in Memorial Square and falls under the supervision of the Department of Parks, Buildings & Recreation Management, the main applicant for this project. The Department and the Board of Park Commissioners are in full support of the project. Please see attached letter from the Board of Park Commissioners.

II. NARRATIVE

The narrative is an opportunity to explain the proposal to the CPC and how the proposal achieves one or more of the CPA criteria. In a separate document, answer the following questions. Keep responses in the same order they are presented here and include the headings for each section.

A. Project Summary

Introduce the project with a summary which notes the CPA category, goals, project scope, and budget. (200 words or less)

The Department of Parks, Buildings and Recreation Management (PBRM), through this grant opportunity, aims to restore and preserve the Spanish American War Memorial monument located in the Memorial Square neighborhood at the intersection of Main Street, Plainfield Street and Bradford Street. The monument has greeted visitors to the North End of Springfield for 114 years and will continue to enhance the character of Springfield with its restoration.

The Spanish American War Memorial, constructed by Melzar Hunt Hosman in 1906, is an 8'ft bronze sculpture of a soldier walking and carrying a gun on a 10'x10' granite base, with four bronze remembrance plaques, one on each side. The Memorial was erected in remembrance of the 2nd Massachusetts Infantry in the War with Spain (1898).

City of Springfield – Department of Parks, Buildings & Recreation Management
Spanish American War Memorial Monument – CPA 2020 Application

PBRM is requesting Community Preservation funding to perform restoration work to preserve the granite and bronze elements of the monument and to make improvements to the terrace in which the monument is situated. The project will include the hiring of an historic preservation consultant to perform a conditions report of the monument and make recommendations for treatments. The results of the study will indicate the necessary rehabilitation work needed to preserve the monument.

B. Proposal Description

1. Describe the proposal and how it will benefit Springfield. (200 words or less)

Springfield has a long and proud history of military service and remembrance. Preservation of the Spanish American War Memorial Monument will ensure the sacrifices of city veterans are acknowledged and honored for future generations. The Spanish American War Memorial Monument has been a historically significant marker within the city for over one hundred years. Since that time, it is witnessed the evolution of the City's urban expansion and renewal. Situated at the gateway to the Memorial Square neighborhood the monument is highly visible to city residents and visitors alike.

It is the intent of PBRM to initiate a historic conditions report, design documents, costs estimate and restoration work to rehabilitate the Spanish American War Memorial Monument with a grant from the Community Preservation Commission.

2. Identify what CPA criteria this proposal achieves and how they are accomplished.

The Spanish American War Memorial Monument project addresses the preservation, rehabilitation and restoration of an historic open space amenity as outlined in the Springfield Community Preservation Plan. The improvements aim to renovate the existing conditions at the Spanish American War Memorial Monument in order to beautify and restore the monument to its full potential as a historically significant asset to Springfield's open space inventory.

The Project is consistent with the priorities identified in the Community Preservation Plan. The restoration of the monument addresses the following plan criteria: to preserve and enhance the essential character of Springfield, to protect open space and recreational resources that may otherwise be threatened, serves more than one CPA purpose, to demonstrate a practical and feasible project that can be implemented within its proposed budget and schedule, to leverage public and/or private funds or voluntary contributions of goods and services, and to utilize Springfield based resources. The project has received endorsements from municipal boards and departments.

3. Describe the need that this proposal will address.

PBRM has identified the restoration and preservation of all city owned monuments as an on-going goal of its Open Space and Recovery Plan (2017). Rehabilitation of the Spanish American War Memorial Monument will address this goal specifically. The Open Space plan is developed with community and resident input and PBRM continually strives to address the recreational needs of the city when completing park renovation projects. Additionally, the restoration of all city owned monuments, including the Spanish American War Memorial Monument, is listed in the City's Capital Improvement Plan, to be completed once funding is available.

4. What is the expected outcome of this proposal?

Completion of this project will implement a preservation and restoration plan for the Spanish American War Memorial Monument. Restoration work will follow the guidelines and recommendations in the Secretary of the Interior's Treatment of Historic Properties by a qualified consultant and vendor. Hands-on restoration work will be completed, and the terrace will be enhanced to provide an improved setting

City of Springfield – Department of Parks, Buildings & Recreation Management
Spanish American War Memorial Monument – CPA 2020 Application

for the display of the monument. As the Monument is located at entrance to the Memorial Square neighborhood, the restoration project will have an immediate and highly visible impact that will increase the aesthetics of this densely populated and highly traveled section of the city.

The following steps may be completed as an outcome of this proposal:

Overview of treatment procedures

1. Inspection and report written by a conservation professional that would include a detailed list of tasks, treatments and approved materials by a qualified professional.
2. The conservator will inspect the memorial and provide the city with a report detailing the condition and the approaches to treatment that they will take.

The objective of the treatment is to repair any structural damage on the bronze and stone (if needed). This can be determined on an up-close inspection which may indicated that the following are needed:

- Repair cracks in bronze, remove Iron Chaplets in bronze, check to make sure the sculpture/plaques are mounted securely, repair mortar or lead joints, identify any missing elements that may have been removed from the bronze (swords, straps, etc.) and recreate and re-attach these elements;
- Restore the surface of bronze to the original/intended surface finish and apply a coating which will protect the surface from environmental degradation; remove superficial corrosion products, re-patina surface to a statuary brown by the application of traditional patina solutions and techniques (research should be done to determine appropriate brown tone), application of a an acrylic coating formulated for use on out-door copper alloys
- Clean stone without using acidic cleaners which can cause lasting damage to stone surface; test appropriate cleaners and proceed using the safest cleaning solution which can remove soiling and accretions.

C. Feasibility & Sustainability

1. What other funding sources have been secured or are being pursued?
 - a. At this time no other funds are anticipated and the department is requesting one hundred percent of the design and restoration costs through this grant application.
2. Once the proposal is complete how will it be sustained/maintained?
 - a. The Spanish American War Memorial Monument will be maintained by the Department of Parks, Buildings and Recreation Management under the direction of Board of Park Commissioners.
3. Is there an operating pro forma for when the proposal is complete and what is the basis?
 - a. No, there is no operating pro forma for this project.

D. Applicant Experience

1. What similar projects/programs has the applicant successfully completed?

The Department of Parks, Buildings & Recreation Management will coordinate and oversee all aspects of the Spanish American War Memorial Monument restoration project. PBRM has a long history of successfully completing park improvements and renovation projects.

City of Springfield – Department of Parks, Buildings & Recreation Management
Spanish American War Memorial Monument – CPA 2020 Application

Furthermore, PBRM plans to procure the services of a qualified restoration firm to ensure all work and materials are in keeping with the guidelines indicated by the Secretary of the Interior to successfully complete the restoration of the Monument. The minimum qualifications would be 10 years' experience treating historic bronze and stone memorials, a list of 5 projects which are similar in scope to this project, references from past projects and proof of membership to the *American Institute for Conservation of Artists and Historic Works* (AIC)—the project manager should be a Professional Associate or Fellow.

2. Describe the professional experience of the applicant/project team.

All projects of PBRM are overseen by its Executive Director, Patrick Sullivan, who has over 30 years of experience in park renovations and improvements. The department will work with qualified consultants and designers to complete the necessary construction and landscaping plans. In the past five years, the DPBRM has completed twenty similar projects, resulting in approximately \$10,000,000 in park improvements.

Working through the City's procurement regulations, a request for qualifications and proposals will be issued for PBRM to hire a consultant firm that is knowledgeable in restoring historic structures to complete construction documents for the rehabilitation of the Monument.

III. TIMELINE

The timeline should identify the estimated start date and estimated completion date along with the completion of phases or important milestones of the project/program. Please provide the timeline in a list format.

- Spring 2020
 - Community Preservation Act Grant Funding application due
- Summer 2020
 - CPA Presentations & Meetings
- Fall 2020
 - CPA Award
 - City Council Recommendation
- Winter 2020-2021
 - Interdepartmental Contract between CPC and DPBRM
 - Request for Qualifications/Proposal for potential historic preservation consultant for conditions report and recommendations and landscape designer for monument and terrace restoration
- Spring 2021
 - Contract with Selected Vendors through City of Springfield Office of Procurement
 - Development of restoration and renovation plans
- Summer 2021
 - Restoration work begins
 - Terrace Improvements begin
- Fall 2021
 - Project Completed

IV. BUDGET - Please see Attachment #1 – Proposed Project Budget

CPA funding will be allocated towards the following:

- Consultant Services
- Design and Engineering Services

City of Springfield – Department of Parks, Buildings & Recreation Management
Spanish American War Memorial Monument – CPA 2020 Application

- Construction

The Spanish American War Memorial Monument budget includes design and engineering services, materials and construction costs. Currently, PBRM is requesting funding of \$125,000, for the restoration of the Spanish American War Memorial Monument from the Community Preservation Committee. Enclosed is a line item budget prepared by the Department of Parks, Buildings & Recreation Management for the necessary work to restore the monument. Should the project move forward with funding, the City of Springfield will issue a request for qualifications through the Office of Procurement to engage the services of a vendor for restoration work.

V. ATTACHMENTS

For all proposals

- A. Commitment letters for revenue sources identified in the budget
 - a. This project does not anticipate revenue other than Community Preservation Act funding.
- B. Letters of Support
 - a. Board of Park Commissioners Support Letter
 - b. Springfield Historical Commission Letter of Support
 - i. The restoration of the Spanish American War Memorial Monument was scheduled to be heard by the SHC on March 19, 2020. Due to COVID-19 precautions, the meeting was postponed and has not been rescheduled at this time. We anticipate the support of the SHC for this project. Enclosed is a copy of the agenda.

For projects that involve property (land/buildings)

- C. Letters of Support from Neighborhood Council/Association where project is located
 - a. Please see attached letter of support from the New North Citizens Council.
- D. Maps
 - 1. Project location on citywide map
 - a. City of Springfield Open Space Map with Project Location
 - b. Memorial Square Historic District Map GIS Aerial Map
 - 2. Plot map (from City GIS) with the project parcel outlined and showing all abutting property parcels and the closest major intersection with streets labeled
 - a. Spanish American War Memorial Monument Property Card GIS Map
- E. Architectural/Engineer Plans/Elevations/Site Plans
 - a. Architectural and Site Plans are not available at this time. Restoration plans will be produced through this grant opportunity.
 - b. National and State Historic Inventory Forms are provided.
- F. Photographs
 - a. Site Photos of Spanish American War Memorial Monument and terrace
- G. Operating Pro Forma (for project after it is complete)
 - a. The Monument will be maintained and operated by the City of Springfield under the direction of the Department of Parks, Buildings and Recreation Management.
- H. Proof of ownership/control of property such as deed(s), executed purchase & sale agreement, option, lease agreement, etc.
 - a. Spanish American War Memorial Monument Property Card

CPA '20

SPANISH AMERICAN WAR MEMORIAL MONUMENT

SOURCE OF FUNDS					TOTAL	CPA '20
4/28/2020					\$ 150,000	\$ 150,000

USES OF FUNDS

VENDOR	DESCRIPTION					
	Historic Review/Consitions Report				\$ 15,000.00	\$ 15,000.00
	Monument Restoration				\$ 50,000.00	\$ 50,000.00
	Designer Services				\$ 10,000.00	\$ 10,000.00
	Benches				\$ 5,000.00	\$ 5,000.00
	Historic Neighborhood Marker				\$ 5,000.00	\$ 5,000.00
	Landscaping & Terrace Improvements				\$ 25,000.00	\$ 25,000.00
					\$ -	\$ -
CONTINGENCY					\$ 40,000.00	\$ 40,000.00
					\$ -	\$ -
					\$ -	\$ -
					\$ -	\$ -
					\$ -	\$ -
					\$ -	\$ -
					\$ -	\$ -
					\$ -	\$ -
					\$ -	\$ -
					\$ -	\$ -
					\$ -	\$ -
					\$ -	\$ -
					\$ -	\$ -
					\$ -	\$ -
					\$ -	\$ -
					\$ -	\$ -
TOTAL					\$ 150,000.00	\$ 150,000.00
DIFFERENCE					\$ -	\$ -

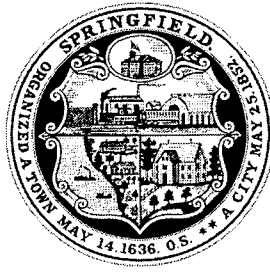

City of Springfield
Parks, Buildings, and Recreation Management

April 7, 2020

Community Preservation Committee
36 Court Street
Springfield, MA 01103

Dear Committee Members,

The Board of Park Commissioners convened a meeting on March 5, 2020 to hear requests from citizens and community organizations relating to Community Preservation Act grant applications.

The Springfield Park Commission enthusiastically supports the Department of Parks, Buildings, and Recreation Management's historic open space application to restore the Spanish American War Memorial Monument.

The Park Commission feels this project is aligned not only with Park Department priorities and need to preserve monuments and markers city-wide, but with the Community Preservation Act priorities to preserve the historic character of the city's streetscapes and historic neighborhoods.

We are available to answer any questions and look forward to working with the Community Preservation Committee and the Park Department to implement this project.

Sincerely,

Brian Santaniello (xmc)

Brian Santaniello,
Board of Park Commissioners, Chairman

cc: Patrick Sullivan, Executive Director of PBRM



70 TAPLEY STREET
SPRINGFIELD, MA 01104
413.787.6020
www.springfield-ma.gov

The Springfield Historical Commission Meeting scheduled for 3/19/20 has been cancelled due to COVID-19 precautions. All agenda items will be heard at the next scheduled meeting to be determined.

MEETING AGENDA

DATE: Thursday, March 19, 2020

TIME: 6:30 PM

PLACE: Room 310, City Hall

I. ROLL CALL & PROCEDURES

II. ACCEPTANCE OF MINUTES

III. TABLED ITEMS

- 1) None

IV. PUBLIC HEARINGS

- 1) **117-119 Firglade Avenue:** Replacement of first floor and basement windows
- 2) **54 Randolph Street:** Installation of front yard fence

V. PRESERVATION OF HISTORICALLY SIGNIFICANT BUILDINGS

- 1) None

VI. OTHER MATTERS PROPERLY BEFORE THE COMMISSION

- 1) **Discussion:** McKnight Community Trail project review
- 2) **Letter of Support:** Massachusetts Historical Commission MPPF grant to conduct a conditions assessment at City Hall
- 3) **Discussion:** Community Preservation Act Historic Determinations / Project Reviews
 - a) **Memorial Square (Spanish American War Monument):** Restoration of monument and the surrounding terrace
 - b) **235 State Street (Classical Condominiums):** Repair/replace windows
 - c) **City of Springfield (Planning & Eco. Dev. / Housing):** Grant funding for program to address repairs of windows and doors, including exterior paint.
- 4) **Discussion:** Certified Local Government
- 5) **Discussion:** Community Outreach
- 6) **Discussion:** Outdoor Mechanical Equipment Guidelines
- 7) **Noncompliance:** Stop work orders to be resolved
- 8) **Public Speak-Out Session**

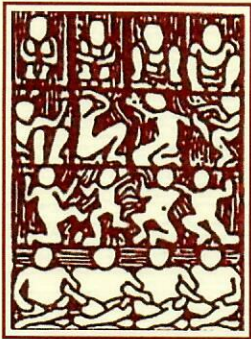

New North Citizens' Council, Inc.

2455 Main Street • Springfield, Massachusetts 01107-1907
413-747-0090 • 413-746-4885 • Fax 413-737-2321

April 17, 2020

Community Preservation Committee
36 Court Street
Springfield, MA 01103

Dear Committee Members,

The New North Citizens Council enthusiastically supports the Department of Parks, Buildings, and Recreation Management's historic open space application to restore the Spanish American War Memorial Monument.

The Spanish American War Memorial Monument serves as a gateway to the Memorial Square neighborhood and adds to the character of Springfield's North End. We welcome the opportunity to work with the Park Department to preserve the monument for future generations of Springfield residents.

We are available to answer any questions and look forward to working with the Community Preservation Committee and the Park Department to implement this project.

Sincerely,

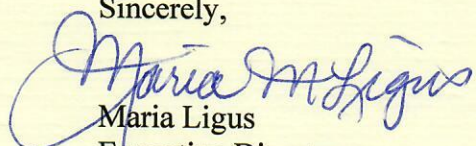
Maria Ligus
Executive Director

cc: Patrick Sullivan, Executive Director of PBRM

**SPANISH AMERICAN WAR
 MEMORIAL MONUMENT**
 Location for CPA '20 Improvements

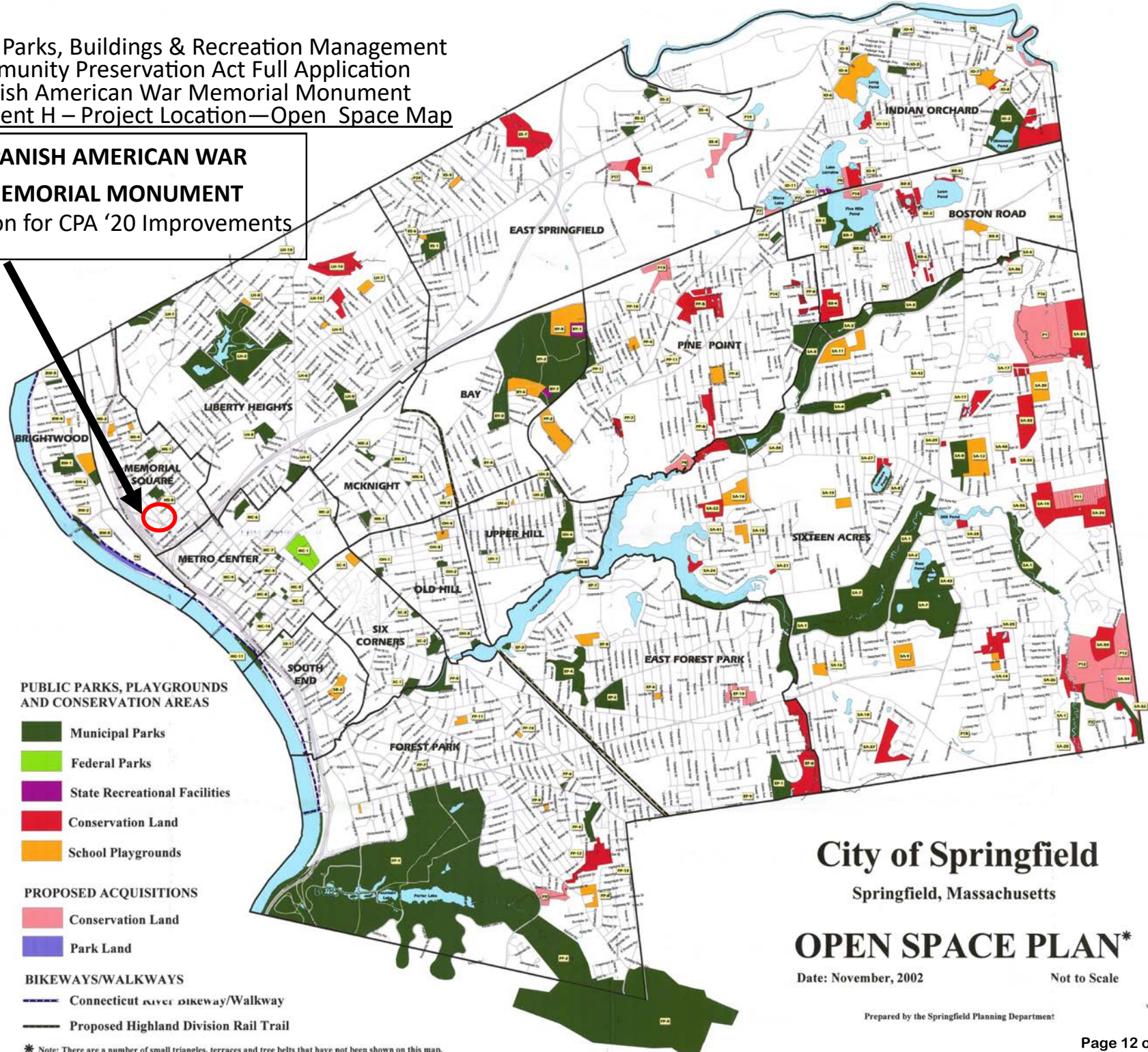

City of Springfield
 Springfield, Massachusetts

OPEN SPACE PLAN*

Date: November, 2002 Not to Scale

Prepared by the Springfield Planning Department



* Note: There are a number of small triangles, terraces and tree belts that have not been shown on this map.

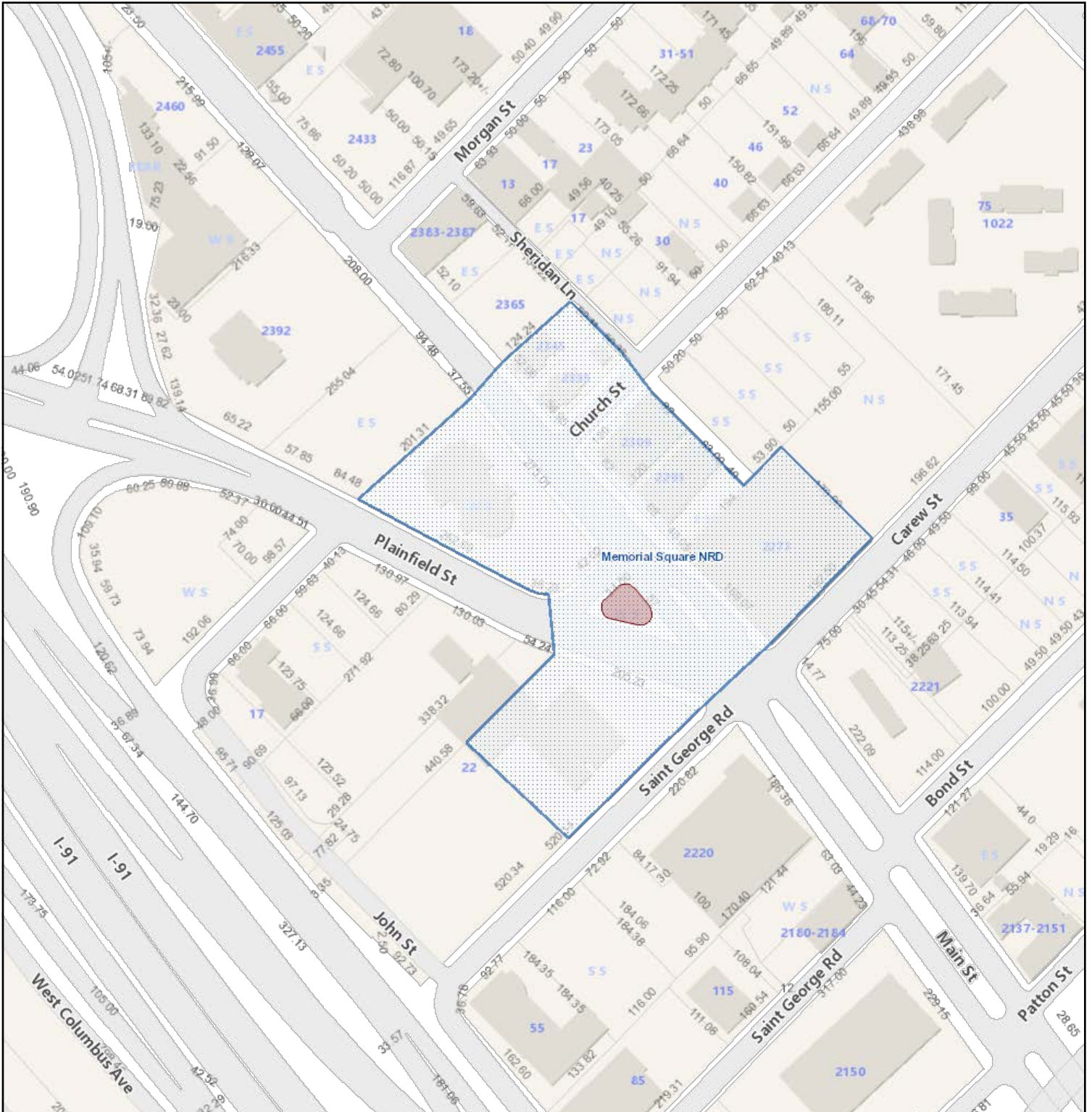

W S MAIN ST

3/12/2020 1:27:33

1"=188'

Property Information

Parcel ID	08130-0212
Owner Name	SPRINGFIELD CITY OF
Owner Address1	
Owner Address2	SPRINGFIELD, MA
Land Area In Square Feet	2,685
Assessed Value	600
Historic	NRD
Zoning Name	Business A



GIS information is provided on these Web Pages as a public resource for general information purposes only. It is used to locate, identify and inventory parcels of land in the City of Springfield for general purposes only and is NOT to be construed or used as a "legal description." Map and parcel information is believed to be accurate but accuracy is not guaranteed. No portion of the information should be considered to be, or used as, a legal document. The information is provided subject to the express condition that the user knowingly waives any and all claims for damages against the City of Springfield that may arise from the use of this data. Information provided on these Web Pages should be verified with the appropriate City department, and reviewed and approved by an attorney or other qualified professional prior to its use for any purpose with potential legal consequences.

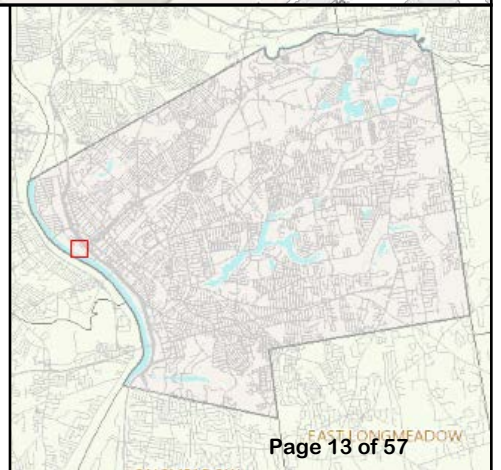

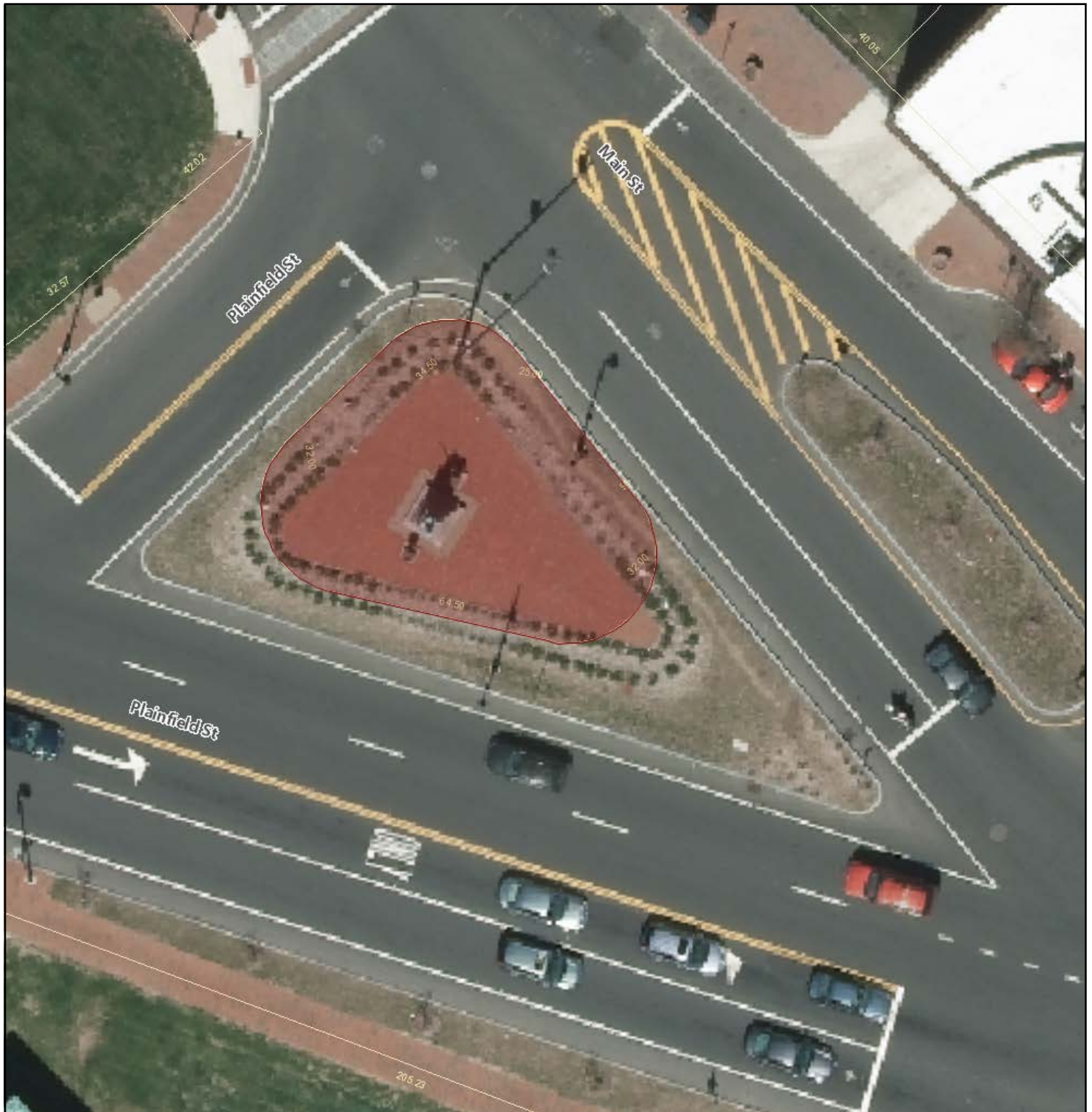

W S MAIN ST Spanish
 2/4/2020 9:35:23 American War
 1"=24' Monument

Property Information

Parcel ID	08130-0212
Owner Name	SPRINGFIELD CITY OF
Owner Address1	
Owner Address2	SPRINGFIELD, MA
Land Area In Square Feet	2,685
Assessed Value	600
Historic	NRD
Zoning Name	Business A



GIS information is provided on these Web Pages as a public resource for general information purposes only. It is used to locate, identify and inventory parcels of land in the City of Springfield for general purposes only and is NOT to be construed or used as a "legal description." Map and parcel information is believed to be accurate but accuracy is not guaranteed. No portion of the information should be considered to be, or used as, a legal document. The information is provided subject to the express condition that the user knowingly waives any and all claims for damages against the City of Springfield that may arise from the use of this data. Information provided on these Web Pages should be verified with the appropriate City department, and reviewed and approved by an attorney or other qualified professional prior to its use for any purpose with potential legal consequences.

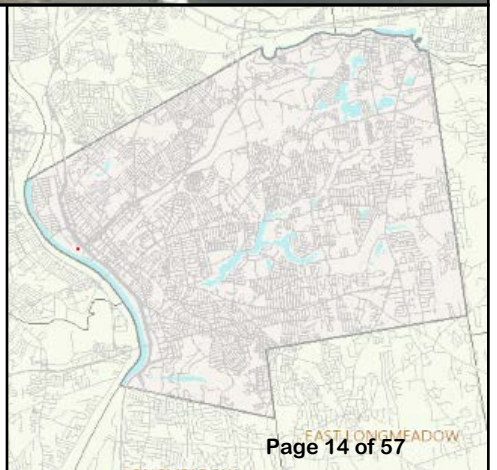

Massachusetts Cultural Resource Information System

Scanned Record Cover Page

Inventory No:	SPR.AS
Historic Name:	Memorial Square Historic District
Common Name:	
Address:	
City/Town:	Springfield
Village/Neighborhood:	Memorial Square
Local No:	
Year Constructed:	
Architect(s):	
Architectural Style(s):	
Use(s):	Other Commercial; Other Governmental or Civic; Other Institutional; Other Residential
Significance:	Architecture; Commerce; Community Planning; Education; Religion; Transportation
Area(s):	
Designation(s):	Nat'l Register District (08/29/1977)
Building Materials(s):	



The Massachusetts Historical Commission (MHC) has converted this paper record to digital format as part of ongoing projects to scan records of the Inventory of Historic Assets of the Commonwealth and National Register of Historic Places nominations for Massachusetts. Efforts are ongoing and not all inventory or National Register records related to this resource may be available in digital format at this time.

The MACRIS database and scanned files are highly dynamic; new information is added daily and both database records and related scanned files may be updated as new information is incorporated into MHC files. Users should note that there may be a considerable lag time between the receipt of new or updated records by MHC and the appearance of related information in MACRIS. Users should also note that not all source materials for the MACRIS database are made available as scanned images. Users may consult the records, files and maps available in MHC's public research area at its offices at the State Archives Building, 220 Morrissey Boulevard, Boston, open M-F, 9-5.

Users of this digital material acknowledge that they have read and understood the MACRIS Information and Disclaimer (<http://mhc-macris.net/macrisdisclaimer.htm>)

Data available via the MACRIS web interface, and associated scanned files are for information purposes only. THE ACT OF CHECKING THIS DATABASE AND ASSOCIATED SCANNED FILES DOES NOT SUBSTITUTE FOR COMPLIANCE WITH APPLICABLE LOCAL, STATE OR FEDERAL LAWS AND REGULATIONS. IF YOU ARE REPRESENTING A DEVELOPER AND/OR A PROPOSED PROJECT THAT WILL REQUIRE A PERMIT, LICENSE OR FUNDING FROM ANY STATE OR FEDERAL AGENCY YOU MUST SUBMIT A PROJECT NOTIFICATION FORM TO MHC FOR MHC'S REVIEW AND COMMENT. You can obtain a copy of a PNF through the MHC web site (www.sec.state.ma.us/mhc) under the subject heading "MHC Forms."

Commonwealth of Massachusetts
Massachusetts Historical Commission
220 Morrissey Boulevard, Boston, Massachusetts 02125
www.sec.state.ma.us/mhc

This file was accessed on: Thursday, March 12, 2020 at 10:56 AM

FORM A - AREA SURVEY

MASSACHUSETTS HISTORICAL COMMISSION
Office of the Secretary, State House, Boston

NR DIS. 2/29/77

Form numbers in this area <u>#301-307</u>	Area no. <u>300</u>
--	------------------------

1. Town SPRINGFIELD AS
Name of area (if any) _____

MEMORIAL SQUARE DIST.

3. General date or period _____
SEE N.R. NOMINATION FORM

4. Is area uniform (explain):
in style? _____
in condition? _____
in type of ownership? _____
in use? _____

2. Photo (3x3" or 3x5")
Staple to left side of form
Photo number _____

5. Map. Use space below to draw a general map of the area involved. Indicate any historic properties for which individual reports are completed on Forms B thru F, using corresponding numbers. Show street names (including route numbers, if any) and indicate north. Indicate with an "x" existing houses not inventoried on Form B.

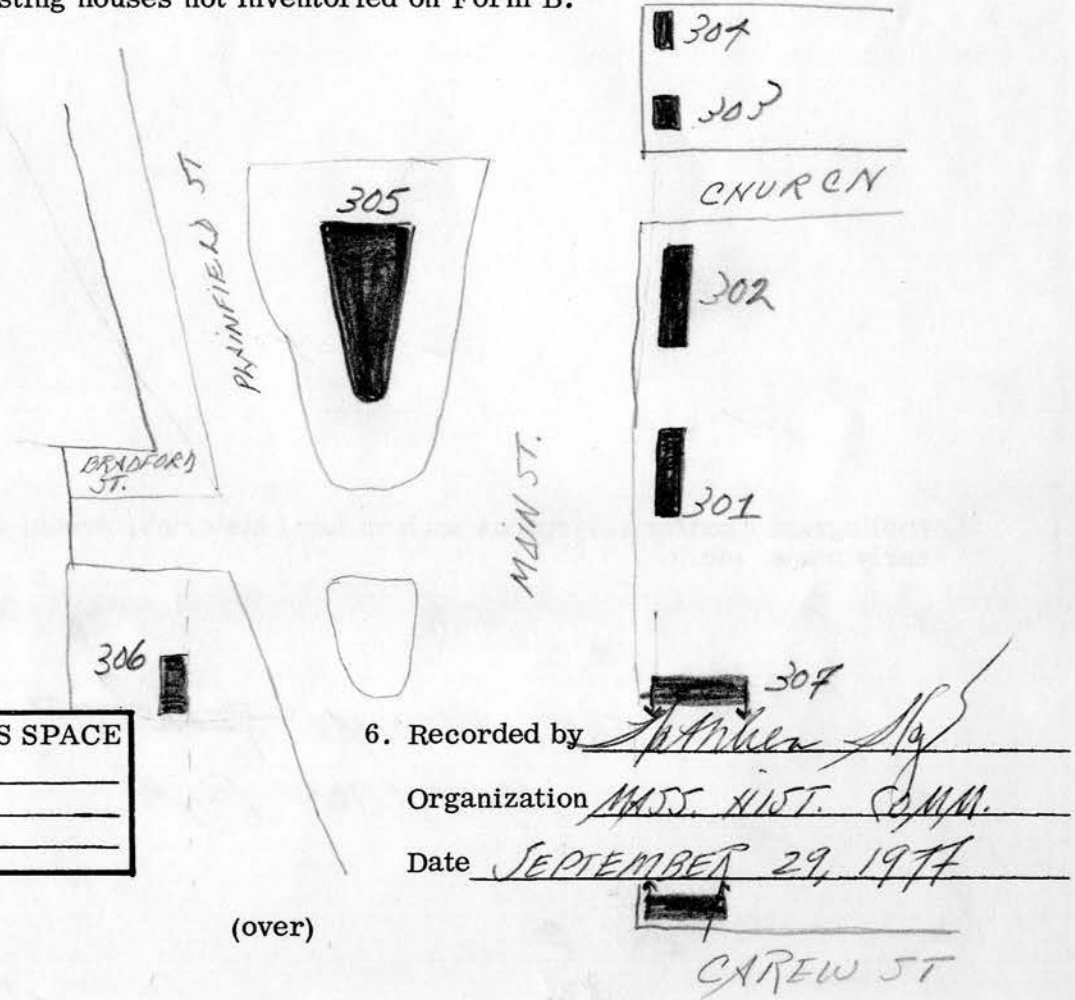

DO NOT WRITE IN THIS SPACE
USGS Quadrant _____
MHC Photo no. _____

6. Recorded by Stephen [Signature]
Organization MASS. HIST. COMM.
Date SEPTEMBER 29, 1977

(over)

7. Historical data. Explain the historical/architectural importance of this area.

SEE NATIONAL REGISTER
NOMINATION FORM

8. Bibliography and/or references such as local histories, deeds, assessor's records, early maps, etc.

SEE NATIONAL REGISTER
NOMINATION FORM

Massachusetts Cultural Resource Information System

Scanned Record Cover Page

Inventory No:	SPR.966
Historic Name:	Springfield Spanish-American War Memorial
Common Name:	
Address:	Main St Memorial Sq
City/Town:	Springfield
Village/Neighborhood:	Memorial Square
Local No:	
Year Constructed:	1906
Architect(s):	Mosman, Melzar Hunt
Architectural Style(s):	
Use(s):	Military Other; Other Governmental or Civic
Significance:	Art; Community Planning; Landscape Architecture; Military; Politics Government
Area(s):	SPR.AS: Memorial Square Historic District
Designation(s):	Nat'l Register District (08/29/1977)
Building Materials(s):	



The Massachusetts Historical Commission (MHC) has converted this paper record to digital format as part of ongoing projects to scan records of the Inventory of Historic Assets of the Commonwealth and National Register of Historic Places nominations for Massachusetts. Efforts are ongoing and not all inventory or National Register records related to this resource may be available in digital format at this time.

The MACRIS database and scanned files are highly dynamic; new information is added daily and both database records and related scanned files may be updated as new information is incorporated into MHC files. Users should note that there may be a considerable lag time between the receipt of new or updated records by MHC and the appearance of related information in MACRIS. Users should also note that not all source materials for the MACRIS database are made available as scanned images. Users may consult the records, files and maps available in MHC's public research area at its offices at the State Archives Building, 220 Morrissey Boulevard, Boston, open M-F, 9-5.

Users of this digital material acknowledge that they have read and understood the MACRIS Information and Disclaimer (<http://mhc-macris.net/macrisdisclaimer.htm>)

Data available via the MACRIS web interface, and associated scanned files are for information purposes only. THE ACT OF CHECKING THIS DATABASE AND ASSOCIATED SCANNED FILES DOES NOT SUBSTITUTE FOR COMPLIANCE WITH APPLICABLE LOCAL, STATE OR FEDERAL LAWS AND REGULATIONS. IF YOU ARE REPRESENTING A DEVELOPER AND/OR A PROPOSED PROJECT THAT WILL REQUIRE A PERMIT, LICENSE OR FUNDING FROM ANY STATE OR FEDERAL AGENCY YOU MUST SUBMIT A PROJECT NOTIFICATION FORM TO MHC FOR MHC'S REVIEW AND COMMENT. You can obtain a copy of a PNF through the MHC web site (www.sec.state.ma.us/mhc) under the subject heading "MHC Forms."

Commonwealth of Massachusetts
Massachusetts Historical Commission
220 Morrissey Boulevard, Boston, Massachusetts 02125
www.sec.state.ma.us/mhc

This file was accessed on: Thursday, March 12, 2020 at 11:01 AM

SPRINGFIELD

AS 8/29/77

SPR. 906

New 966 (B)

A MEM SQ
USE SPANB, S
SOTA

SOS! Survey Questionnaire

Save Outdoor Sculpture!, National Institute for the Conservation of Cultural Property
3299 K Street, NW, Washington, D.C. 20007 (1-800-421-1381)

- Read the entire form carefully before beginning the survey.
- Type or print using a ballpoint pen when filling out this form. Legibility is critical.
- Do not guess at the information; an answer of "Unknown" is more helpful.
- For sculptures with several separate sculptural components, complete one questionnaire for the entire work. If necessary, complete relevant sections of the *SOS! Survey Questionnaire* for each component and staple them together.
- If possible, attach a photograph, photocopy, slide or other reproduction of the sculpture to this form.
- Refer to *SOS! Handbook* for further clarification of terminology.
- Contact your local SOS! Project Coordinator if you have any questions.

PART I: BASIC DESCRIPTIVE INFORMATION

Title of Work (if unsure, note "unknown"; if artist named work "Untitled," note accordingly)
Spanish American Veterans Memorial

Alternate Title(s) _____

Primary Artist(s) Melzer Hunt Hosman

Person(s) responsible for the overall conception and creation of the work. Frequently the artist's name will appear toward the back, lower edge or another inconspicuous place on the sculpture, followed by the abbreviations "Sc." "Sculp" for sculptor/sculpted.

Other Collaborators (check as many as apply).

- Carver _____
- Designer _____
- Architect _____
- Other (Designate role, e.g., landscape architect, engineer) _____

Foundry/Fabricator
If the piece was cast, the foundry name or monogram symbol, as well as cast date, may appear on the base of the sculpture or another inconspicuous place.

Execution Date (often found by sculptor's name) 1906

Other Dates (check as many as apply) _____

Other dates to report might include the date the sculpture was commissioned, copyrighted, cast (often found beside the foundry's name) or dedicated.

- Cast _____
- Copyright _____
- Dedicated _____

RECEIVED

OCT 05 2001

27

MASS. HIST. COMM

Media (material(s) sculpture/base made of)

- Sculpture: Ceramic Concrete Glass Metal
 Plastic Stone Water Wood
 Undetermined Other (specify) _____

If known, name specific medium (e.g., bronze, Cor-Ten steel, oak, fiberglass)

_____ *bronze* _____

Base (if media differs from sculpture, please indicate)

- Ceramic Concrete Glass Metal
 Plastic Stone Water Wood
 Undetermined Other (specify) _____

If known, name specific medium (e.g., granite, marble, limestone, concrete)

_____ *granite* _____

Was information obtained by direct observation? Yes No

If no, attach photocopy of source.

Approximate Dimensions (indicate unit of measure)

Always measure from the tallest and widest points.

Sculpture: Height 8' Width _____ Depth _____ or Diameter _____
 Base: Height 10' Width 10' Depth 10' or Diameter _____

Markings/Inscriptions (check as many as apply)

Is the artist's signature visible on the piece?

- Yes, examined and found signature
 No, examined sculpture/base but did not see any signature
 Unable to determine, couldn't get close enough to check

If signature is visible, record here: - M H MOSMAN, Scul

Does the work have foundry/fabricator marks?

- Yes, examined and found foundry marks
 No, examined sculpture/base but did not see foundry mark
 Unable to determine, couldn't get close enough to check

If foundry mark/mark is visible, record here: _____

Record the signature(s) and any additional markings or inscriptions that appear on the sculpture or base.

Indicate their location (e.g., back of base, lower left). Use a slash (/) to indicate separate lines of inscription.

Record the text of any associated nearby identification or commemorative plaques.

Second Massachusetts Infantry U.S.V
War with Spain 1908
erected by friends of the regiment in
everlasting remembrance

Are any inscriptions badly worn or unreadable? Yes No Unable to determine

PART II: LOCATION/JURISDICTION INFORMATION

The sculpture is currently located at:

Street address or site location Memorial Sq. - Bradford, Main + Plainfield Sts.

City Springfield County _____ State Ma.

Owner/Administrator (name of agency, institution or individual that currently owns or administers the sculpture and is responsible for its long-term care)

Name City of Springfield

Department/Division _____

Street Address _____

City Springfield State MA Zip Code _____

Contact Name _____ Telephone () _____

If sculpture has been moved, please list former location(s) or owner(s).

Environmental Setting (The general vicinity and immediate locale surrounding a sculpture play a major role in its overall condition.)

Location Type (check as many as apply to immediate surroundings)

- | | | |
|--|--|--|
| <input type="checkbox"/> Battlefield | <input type="checkbox"/> Bridge | <input type="checkbox"/> Cemetery |
| <input type="checkbox"/> College Campus | <input type="checkbox"/> Courthouse | <input type="checkbox"/> Garden |
| <input type="checkbox"/> Library | <input type="checkbox"/> Municipal Building | <input type="checkbox"/> Park |
| <input type="checkbox"/> Plaza/Courtyard | <input type="checkbox"/> Post Office | <input checked="" type="checkbox"/> Religious Building |
| <input type="checkbox"/> School | <input type="checkbox"/> Sports Facility | <input type="checkbox"/> State Capitol |
| <input type="checkbox"/> Town Square | <input checked="" type="checkbox"/> Traffic Circle | <input type="checkbox"/> Transit Facility |
| <input type="checkbox"/> Zoo | <input type="checkbox"/> Other (specify) _____ | |

General Vicinity (check as many as apply)

- | | |
|--|---|
| <input type="checkbox"/> Rural (low population, open land) | <input type="checkbox"/> Suburban (residential setting near a major city) |
| <input type="checkbox"/> Town | <input checked="" type="checkbox"/> Urban/metropolitan |
| <input type="checkbox"/> Coastal (bordering salt water) | <input type="checkbox"/> Desert |
| <input type="checkbox"/> Plains (valley or plateau lands) | <input type="checkbox"/> Mountain |

Immediate Locale (check as many as apply)

- Industrial
- Street/Roadside (within 20 feet)
- Tree Covered (overhanging branches or trees nearby)

Is the sculpture in a protected setting? (check if applicable)

- Protected from the elements (e.g., niche, canopy)
- Protected from the public (e.g., fenced)

Any other significant environmental factor (i.e., near airport or subway)?

PART III: CONDITION INFORMATION

Structural Condition (check as many as apply)

Instability in the sculpture and its base can be detected by a number of factors. Indicators may be obvious or subtle. Visually examine the sculpture and its base.

	Sculpture	Base
Is the armature/internal support unstable/exposed? (look for signs of exterior rust)	<input type="checkbox"/>	<input type="checkbox"/>
Any evidence of structurally instability? (look for cracked joints, missing mortar or caulking or plant growth)	<input type="checkbox"/>	<input type="checkbox"/>
Any broken or missing parts? (look for elements (i.e., sword, rifle, nose) that are missing due to vandalism, fluctuating weather conditions, etc.)	<input type="checkbox"/>	<input type="checkbox"/>
Any cracks, splits, breaks or holes? (look for fractures, straight-line or branching, which could indicate uneven stress or weakness in the material)	<input type="checkbox"/>	<input type="checkbox"/>

Surface Appearance (check as many as apply)

	Sculpture	Base
Bird guano (e.g., bird droppings, other animal/insect remains)	<input checked="" type="checkbox"/>	<input type="checkbox"/>
Black crusts	<input type="checkbox"/>	<input type="checkbox"/>
Etched, pitted or otherwise corroded (usually applies to metal)	<input checked="" type="checkbox"/>	<input type="checkbox"/>
Metallic staining (e.g., run-off from copper, iron, etc.)	<input type="checkbox"/>	<input type="checkbox"/>
Organic growth (e.g., moss, algae, lichen or vines)	<input type="checkbox"/>	<input type="checkbox"/>
White crusts	<input type="checkbox"/>	<input type="checkbox"/>
Chalky or powdery (applies to stone only)	<input type="checkbox"/>	<input type="checkbox"/>
Granular, sugary or eroding (applies to stone only)	<input type="checkbox"/>	<input type="checkbox"/>
Spalling or sloughing (applies to stone only) (parallel splitting off of the surfaces)	<input type="checkbox"/>	<input type="checkbox"/>
Other (e.g., applied adhesives, spray paint, graffiti, gouges)		

Does water collect in recessed areas of the sculpture and/or base?
 Yes No Unable to determine

Surface Coating

Does there appear to be a coating?

- Yes
- No
- Unable to determine

If known, identify type of coating.

- Gilded
- Painted
- Varnished
- Waxed
- Unable to determine

Is the coating in good condition?

- Yes
- No
- Unable to determine

Basic Surface Condition Assessment (check one)

In your opinion, what is the general appearance or condition of the sculpture?

- In urgent need of treatment
- Well-maintained
- Would benefit from treatment
- Unable to determine

PART IV: OVERALL DESCRIPTION

Briefly describe the sculpture, its subject/theme and its overall condition. For figurative works, use the abbreviations PR (proper right) and PL (proper left) to indicate the right or left side of the statue from the perspective of the statue (i.e., your right or left side if you were positioned on the base facing in the same direction as the statue). For abstract works, describe the predominant forms, colors, shapes and textures. For descriptions of either abstract and figurative pieces, avoid judgmental language. For condition, indicate any broken or missing parts and describe evidence of cracks, graffiti, etc.

bronze figure of soldier carrying a gun walking on tall granite base with inscribed bronze plaques on all four sides

PART V: SUPPLEMENTAL BACKGROUND MATERIALS

In addition to your on-site survey, any supplemental secondary information you can provide related to the artist or portrait subject, to the historical commissioning, patronage or funding of the work, as well as previous conservation treatment histories will be welcomed. When citing sources, provide enough detail to enable researchers to locate the information easily. Include the full citations of each source (i.e., author, title, publisher, date, pages). If possible, photocopy source materials and attach. Make sure attached sources are clearly identified.

Book _____

Magazine or journal article _____

Newspaper article or account _____

Unpublished archival or manuscript materials _____

Other (specify) _____

Where can a photograph or illustration of the work be obtained?

If photographic image is attached, please identify type of image.

Photograph

Photocopy

Slide

Illustration

Other (specify) _____

PART VI: SURVEYOR INFORMATION AND WAIVER

Date of On-site Survey 12/97

Waiver of Liability, Photographic and Data Rights for Volunteers, Agents or Employee Participants

I acknowledge that I am a participant in Save Outdoor Sculpture!, a project cosponsored by the National Institute for the Conservation of Cultural Property (NIC) and the National Museum of American Art, Smithsonian Institution. The project's purpose is to determine the location, description and basic condition of sculpture in the United States, to raise awareness about the condition of our nation's sculpture and to promote its long-term care and maintenance.

In furtherance of these objectives, I will record certain information on the SOS! Survey Questionnaire, provide certain illustrations and take certain photographs. I hereby declare that, to the extent these text, illustrations and photographs may be eligible for copyright protection, all of my rights and interest in them are hereby waived. It is my intention to place these written works, illustrations and photographs in the public domain and I warrant that I will not assert any copyright claim in them.

I further declare and acknowledge that I am a volunteer, agent or employee for my sponsoring organization and am not a volunteer, agent or employee of the Smithsonian Institution or the NIC. I agree to hold harmless the NIC and Smithsonian, its museums, bureaus, entities, employees and officials from any and all damages, injuries or claims that may arise out of my participation in the SOS! project.

This waiver shall be effective as of the date below.

LYNNE SPENCER
Typed or Printed Name of Participant

Box 58
Address

Nahant Ma 01908
City State Zip

Lynne Spencer
Signature of Participant

Fill in blanks below and return to your local SOS! Project Coordinator.

Name _____

Address _____ City _____

State _____ Zip Code _____ Telephone () _____

Massachusetts Save Outdoor Sculpture!

Addenda # 1:

Massachusetts SOS! requests the following additional information to assist with our state-wide survey for inclusion in the Massachusetts Historical Commission records:

SKETCH MAP: Draw a map showing the sculpture's location in relation to the nearest cross street and/or major natural features. Show all buildings and their relationships to the piece. Label streets including route numbers, if any. Circle and number the inventories sculpture. Indicate north.

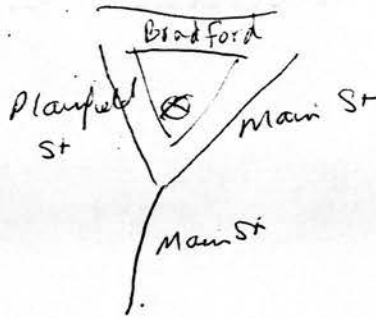

SKETCH MAP FOR COMPLEXES: Provide a sketch map for sculptures that are part of a larger complex such as a plaza, courtyard or the like.

Addenda # 2

This is optional but valuable information which synthesizes your research as directed on page 7 of the SOS! form --

HISTORICAL NARRATIVE: Explain the history of the sculpture and how it relates to the development of the community. This can explore its intention or use, its association with specific individuals and groups, and its relationship to local historical trends and events. Associations include those connections with artists, designers, owners, groups or organizations. If the sculpture is commemorative, describe the event (s) or person (s) commemorated.

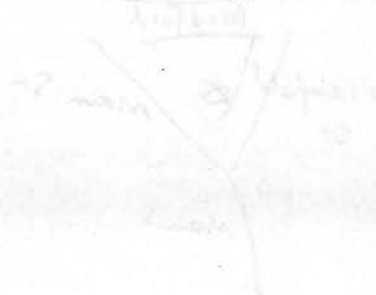

SEARCH MAP FOR COMPLEXES Provide a sketch map for sculptures that are part of a larger complex such as a park, courtyard or the like.





UNITED STATES DEPARTMENT OF THE INTERIOR
NATIONAL PARK SERVICE

**NATIONAL REGISTER OF HISTORIC PLACES
INVENTORY -- NOMINATION FORM**

FOR NPS USE ONLY

RECEIVED

DATE ENTERED

SEE INSTRUCTIONS IN *HOW TO COMPLETE NATIONAL REGISTER FORMS*
TYPE ALL ENTRIES -- COMPLETE APPLICABLE SECTIONS

1 NAME

HISTORIC Memorial Square District

AND/OR COMMON
Same

2 LOCATION

STREET & NUMBER
Multiple

CITY, TOWN

Springfield

VICINITY OF

NOT FOR PUBLICATION
CONGRESSIONAL DISTRICT

2nd

STATE

Massachusetts

CODE

01104

COUNTY

Hampden

CODE

013

3 CLASSIFICATION

CATEGORY	OWNERSHIP	STATUS	PRESENT USE
<input checked="" type="checkbox"/> DISTRICT	<input type="checkbox"/> PUBLIC	<input checked="" type="checkbox"/> OCCUPIED	<input type="checkbox"/> AGRICULTURE <input type="checkbox"/> MUSEUM
<input type="checkbox"/> BUILDING(S)	<input checked="" type="checkbox"/> PRIVATE	<input type="checkbox"/> UNOCCUPIED	<input type="checkbox"/> COMMERCIAL <input checked="" type="checkbox"/> PARK
<input type="checkbox"/> STRUCTURE	<input type="checkbox"/> BOTH	<input type="checkbox"/> WORK IN PROGRESS	<input type="checkbox"/> EDUCATIONAL <input checked="" type="checkbox"/> PRIVATE RESIDENCE
<input type="checkbox"/> SITE	PUBLIC ACQUISITION	ACCESSIBLE	<input type="checkbox"/> ENTERTAINMENT <input checked="" type="checkbox"/> RELIGIOUS
<input type="checkbox"/> OBJECT	<input type="checkbox"/> IN PROCESS	<input type="checkbox"/> YES: RESTRICTED	<input type="checkbox"/> GOVERNMENT <input type="checkbox"/> SCIENTIFIC
	<input checked="" type="checkbox"/> BEING CONSIDERED	<input checked="" type="checkbox"/> YES: UNRESTRICTED	<input type="checkbox"/> INDUSTRIAL <input checked="" type="checkbox"/> TRANSPORTATION
		<input type="checkbox"/> NO	<input type="checkbox"/> MILITARY <input type="checkbox"/> OTHER:

4 OWNER OF PROPERTY

NAME
Multiple

STREET & NUMBER

CITY, TOWN

Springfield

VICINITY OF

STATE

Massachusetts

5 LOCATION OF LEGAL DESCRIPTION

COURTHOUSE,
REGISTRY OF DEEDS, ETC. Hampden County Registry of Deeds

STREET & NUMBER

55 Elm Street

CITY, TOWN

Springfield,

STATE

Massachusetts, 01104

6 REPRESENTATION IN EXISTING SURVEYS

TITLE
Inventory of the Historic Assets of the Commonwealth

DATE

1977

FEDERAL STATE COUNTY LOCAL

DEPOSITORY FOR
SURVEY RECORDS

Massachusetts Historical Commission

CITY, TOWN

Boston

STATE
Massachusetts, 02108

7 DESCRIPTION

CONDITION		CHECK ONE	CHECK ONE
<input type="checkbox"/> EXCELLENT	<input type="checkbox"/> DETERIORATED	<input checked="" type="checkbox"/> UNALTERED	<input checked="" type="checkbox"/> ORIGINAL SITE
<input checked="" type="checkbox"/> GOOD	<input type="checkbox"/> RUINS	<input type="checkbox"/> ALTERED	<input type="checkbox"/> MOVED DATE _____
<input type="checkbox"/> FAIR	<input type="checkbox"/> UNEXPOSED		

DESCRIBE THE PRESENT AND ORIGINAL (IF KNOWN) PHYSICAL APPEARANCE

The Memorial Square District is located in the northwestern section of Springfield at the western section of Main and Plainfield Streets. Six of the seven district buildings are loosely grouped around this intersection, with Memorial Church acting as the focal point. Four of the buildings are public and commercial structures dating from the 1890's and the first decade of the 20th century. Also included in the district are two Queen Anne houses built during the 1880's, a small park, and the Memorial Square island at the intersection of Main and Plainfield Streets. The area is surrounded by residential and commercial buildings, and an urban renewal region to the southwest.

MEMORIAL CHURCH (#1) is an imposing Gothic Revival structure designed by Richard Upjohn and his son, R. M. Upjohn and was completed in 1866. The church was constructed of local materials, primarily grey Monson granite with Longmeadow brownstone trim. Fenestration is varied. The larger windows are Gothic arched; the smaller are trefoil arched. There are 10 feet diameter rose windows in the gable ends of the transept and in the northern end gable. Two entrances on both the east and west elevations are highlighted by archivolt with alternating light and dark stone voussoirs. The slate roof is polychromatic. The church has a cruciform plan with an hexagonal apse to the south. Between this hexagonal apse and the eastern wing of the transept rises a granite tower with ornate brownstone trim in the belfry. The tower is capped by a multifoil brownstone balustrade. There are two subsidiary rooms flanking the nave at the northern end of the church, each one story high with a Mansard roof.

At each angle of the hexagon apse is a buttress extending up from the foundation and terminating in brownstone capped pinnacles. These pinnacles rise to the same height as the five Gothic style dormers which crown the hip roof of the hexagon.

MEMORIAL SQUARE LIBRARY (#2) was designed by Edward Tilton of New York, and two local architects, E. C. and G. L. Gardner. It was built in 1914 in an adaptation of the Italian Renaissance style. The building is of buff brick ornamented with limestone. It is capped by a red tile hip roof with widely projecting eaves and exposed rafters.

The center entrance on the symmetrical east facade is flanked by three bays. It is distinguished by a dentiled entablature headed by modillions beneath the projecting cornice which is supported by stone scroll brackets. A limestone string-course separated the partially exposed basement from the floor above. Fenestration is recessed panels containing double windows over a smaller 1/1 window. These window panels are defined by brick pilasters with limestone capitals. The entablature of the building is decorated by a corbelled table. The building is four bays deep. It has recently been purchased privately, and will house a funeral home.

UNITED STATES DEPARTMENT OF THE INTERIOR
NATIONAL PARK SERVICE

FOR NPS USE ONLY
RECEIVED
DATE ENTERED

**NATIONAL REGISTER OF HISTORIC PLACES
INVENTORY -- NOMINATION FORM**

CONTINUATION SHEET	ITEM NUMBER	PAGE
--------------------	-------------	------

Memorial Square District	7	1
--------------------------	---	---

#3 is a small triangular park in front of the library in which stands a Spanish-American War Memorial statue. It is of bronze, and portrays one of Springfield's "Boys of '98", replete with bedroll, cartridge belt and pouch, food packs, canteen, and Springfield rifle. The designer was Melzar H. Mosman of Chicopee.

THE SPRINGFIELD STREET RAILWAY BUILDING (#5) was designed by the local architectural firm of Gardner, Pyne, and Gardner, and was built in 1897. A two story office building of buff brick with a granite foundation and brownstone and terra cotta trim fronts and adjoins a large brick car barn. The twenty bay wide facade faces west toward Main Street. The northern end is a six bay wide section which is a 1/2 story shorter than the main section. It contains a three bay wide car entrance. Two windows and a door are headed by a continuous brownstone lintel on the first story. Triple arched windows on the second story are headed by a continuous segmentally arched cornice. An off center arched entrance-way dominates the facade. Its double doors are recessed behind a massive brownstone and terra cotta arch. The crown of the arch is decorated with stylized trolley wheels radiating electric bolts. The entrance is flanked by double windows headed by brownstone lintels. These in turn are flanked by triple arched windows with fanlights headed by delicately detailed projecting arched cornices and tied together by ornamented terra cotta impost. All of the first story windows have brownstone sills. A brownstone stringcourse defines the first and second story. The second story, directly above the entrance section, is composed of five bays with linked terra cotta archivolt. To either side of these is a group of segmentally arched windows headed by vertical brick voussoirs and a terra cotta cornice. These six windows are each crowned by a floral terra cotta tile. These tiles and a central terra cotta frieze are separated from the second story by a brownstone stringcourse. The central frieze is surmounted by a brownstone parapet. All of the second story windows are tied together by a continuous brownstone sill.

The south elevation of the office building is identical to the two sections flanking the facade entrance, with the exception of the first and second floor windows in the center of this three bay section which are replaced by terra cotta frames over the brick sheathing.

THE MEMORIAL SQUARE BUILDING (#6) is a six story structure built in 1911. The first story is faced with limestone, and houses stores. The five stories of apartments

UNITED STATES DEPARTMENT OF THE INTERIOR
NATIONAL PARK SERVICE

FOR NPS USE ONLY

RECEIVED

DATE ENTERED

**NATIONAL REGISTER OF HISTORIC PLACES
INVENTORY -- NOMINATION FORM**

CONTINUATION SHEET

ITEM NUMBER

PAGE

Memorial Square District

7

2

above are brick. The facade faces west toward Main Street. It is accented by oriel windows which run from the second through the fifth stories in height. Limestone trimwork ornaments the fifth and sixth stories. Glazed yellow brick decorates the top floor.

THE MEMORIAL CHURCH PARISH HOUSE (#7) was designed in the Classical Revival style by Springfield architect, F. R. Richmond, and built in 1894. The two story brick building has a hip roof. The facade faces west toward Main Street. Its three bays are defined by four brick Doric pilasters. Six stone steps lead to the arched recessed center entrance. Double wooden doors are headed by a fanlight. The arch itself is supported by simple engaged brownstone columns. The entrance is headed by a tripart window on the second story. It is framed by a brownstone sill and lintel, and is divided by short engaged brownstone columns. To either side of the center section is a triangularly pedimented gable section. These pediments are each ornamented by a dentiled cornice and a corbelled triangle in the center of the tympanum. Both of these bays contain two windows in the exposed basement story, a tripart window with transoms on the first story, and a Palladian window surmounted by cut brownstone and ornamental brick archivolt with keystone on the second story. All four of these windows have rough brownstone sills and lintels, and are separated into their three parts by brownstone columns. A continuous brownstone frieze runs across the facade and bears the inscription "Memorial Church - 1894 - Parish House". This is headed by a dentiled cornice.

The north elevation has a triangularly pedimented section resembling the two on the facade, except that it is larger, and is divided into three parts by brick engaged columns. The second story windows in this section are arched with brownstone architraves and ornamental brick archivolt. These three windows contain stained glass. The center Palladian window glass is from Tiffany Studios. The entire section projects slightly from the remainder of the elevation, and has three bays of double windows and a scaled down version of the facade entrance.

The south elevation is similar to the north; it has no entrance, nor stained glass. A roof balustrade encircles the building between each pediment.

THE R. HALE SMITH HOUSE (#8), built in 1883, is believed to have been designed by local architects F. R. Richmond and B. H. Seabury. The two and a half story Queen Anne style house is of red and black brick, with terra cotta, and cut glass in stucco ornamentation, and brownstone trim. The slate roof is irregular with

UNITED STATES DEPARTMENT OF THE INTERIOR
NATIONAL PARK SERVICE

FOR NPS USE ONLY

RECEIVED

DATE ENTERED

**NATIONAL REGISTER OF HISTORIC PLACES
INVENTORY -- NOMINATION FORM**

CONTINUATION SHEET

ITEM NUMBER

PAGE

Memorial Square District

7

3

intersecting gables and gablets, Continuous stringcourses and bands run around the building tying all the window sills and cornices together. Rough brown-stone separates the exposed basement from the first story. All of the first story windows have stained glass transoms.

The facade faces east toward Main Street. It has two projecting bays. The southern 2½ story bay is topped by a gable supported by delicate brackets. The bay is decorated by a large three part terra cotta design between the first and second story windows; a matrix of geometrically designed terra cotta tiles between the second story windows and those in the gable; a semi circular mosaic of cut glass above the gable window, and a triangular terra cotta design in the gable peak.

The northern two story bay is narrower. It is capped by a small hipped gable containing a mosaic of cut glass. The bay is fronted by a ridge roof, open, one story porch with balustrade. In the porch gable is a mosaic of small cut stones in the radiating fan pattern. The floor is made up of ornamental cut tile.

The south elevation has a central projecting rectangular bay topped by a cross gable. The bay is ornamented by a checker board pattern of red and black brick butt-ends between the two windows on the second floor, and a mosaic of cut glass interspersed with diagonal lathing above the double window in the gable. The east end of the elevation has a one story shed roof porch with turned balustrade. Above this is a single window on the second story. Immediately west of the projection are two small wooden frame balconies with balustrades, one on the first floor, one on the second.

A tall chimney projects to the west of the balconies. The first story portion of the chimney features a large floral terra cotta panel, defined by a black brick band below and above.

The north elevation is similar to the south, but has no porches or chimney. In place of the chimney are three narrow stained glass windows in an ascending series between the first and second stories.

A terra cotta cornice runs beneath the eaves on the north and south elevations. Beneath this is a frieze of red bricks on end, diagonally placed and outlined by black brick, which extends around the corners to the facade.

UNITED STATES DEPARTMENT OF THE INTERIOR
NATIONAL PARK SERVICE

FOR NPS USE ONLY

RECEIVED

DATE ENTERED

**NATIONAL REGISTER OF HISTORIC PLACES
INVENTORY -- NOMINATION FORM**

CONTINUATION SHEET

ITEM NUMBER

PAGE

Memorial Square District

7

4

A two story brick ell projects from the east (rear) elevation. It is ornamented with black brick banding, brownstone sills and lintels, floral terra cotta, and decorative shingle patterns in the gable.

Finials and iron cresting have been removed from the roof of the house.

THE E. S. SWEATLAND HOUSE (#9) was built in 1886 in the Queen Anne style. It is also believed to have been designed by F. R. Richmond and B. H. Seabury. The 2½ story brick structure is of the same overall form as the Smith House (#8) except for modification of the facade and a more sparing use of ornamentation. The entire house has been painted white, with all brownstone trim painted black. Rough cut brownstone is used for all window sills and lintels and for a string-course defining the basement and first floor. The lintels on the first and second story windows are connected by terra cotta tiles, as are the sills on the first story. The first story lintels are connected by decorative cut black brick butts.

The facade faces west toward Main Street. It contains two projecting bays which are joined by the large third story gable. Cornice brickwork is used to create the effect of a broken pediment in the gable with terra cotta tiles as trim inside. A one story ridge roof porch with balustrade projects from the northern end. It is of the same design as that on the Smith House but the mosaic pattern in the gable is varied.

The south elevation has the same chimney, gabled bay, and porch arrangement as the Smith House. The gable contains only one window, and has the same brickwork design under the eaves as that on the facade.

The north elevation is like the south, without the porch and chimney.

A two story brick ell identical to the one next door on the Smith House projects from the rear elevation.

The buildings which compose the Memorial Square District have changed very little over the years, but the surrounding area has been altered significantly. Round Hill, to the northwest of Memorial Church has been levelled. A bottling plant

UNITED STATES DEPARTMENT OF THE INTERIOR
NATIONAL PARK SERVICE

FOR NPS USE ONLY

RECEIVED

DATE ENTERED

**NATIONAL REGISTER OF HISTORIC PLACES
INVENTORY -- NOMINATION FORM**

CONTINUATION SHEET

ITEM NUMBER

PAGE

Memorial Square District

7

5

was built directly behind Memorial Church in the late 1940's.

Interstate 91 and its ramps curves through the area. Widening of roadway and Dutch Elm disease destroyed many of the trees that shaded the Square and made up the Main Street terrace. The urban Renewal and Interstate 291, south of the Square caused severe drop in population.

8 SIGNIFICANCE

PERIOD	AREAS OF SIGNIFICANCE -- CHECK AND JUSTIFY BELOW			
<input type="checkbox"/> PREHISTORIC	<input type="checkbox"/> ARCHEOLOGY-PREHISTORIC	<input type="checkbox"/> COMMUNITY PLANNING	<input type="checkbox"/> LANDSCAPE ARCHITECTURE	<input checked="" type="checkbox"/> RELIGION
<input type="checkbox"/> 1400-1499	<input type="checkbox"/> ARCHEOLOGY-HISTORIC	<input type="checkbox"/> CONSERVATION	<input type="checkbox"/> LAW	<input type="checkbox"/> SCIENCE
<input type="checkbox"/> 1500-1599	<input type="checkbox"/> AGRICULTURE	<input type="checkbox"/> ECONOMICS	<input type="checkbox"/> LITERATURE	<input checked="" type="checkbox"/> SCULPTURE
<input type="checkbox"/> 1600-1699	<input checked="" type="checkbox"/> ARCHITECTURE	<input checked="" type="checkbox"/> EDUCATION	<input type="checkbox"/> MILITARY	<input type="checkbox"/> SOCIAL/HUMANITARIAN
<input type="checkbox"/> 1700-1799	<input checked="" type="checkbox"/> ART	<input type="checkbox"/> ENGINEERING	<input type="checkbox"/> MUSIC	<input type="checkbox"/> THEATER
<input checked="" type="checkbox"/> 1800-1899	<input checked="" type="checkbox"/> COMMERCE	<input type="checkbox"/> EXPLORATION/SETTLEMENT	<input type="checkbox"/> PHILOSOPHY	<input checked="" type="checkbox"/> TRANSPORTATION
<input checked="" type="checkbox"/> 1900-	<input type="checkbox"/> COMMUNICATIONS	<input type="checkbox"/> INDUSTRY	<input type="checkbox"/> POLITICS/GOVERNMENT	<input type="checkbox"/> OTHER (SPECIFY)
		<input type="checkbox"/> INVENTION		

SPECIFIC DATES

BUILDER/ARCHITECT

STATEMENT OF SIGNIFICANCE

The Memorial Square District is significant both as the focal point for the two northwestern neighborhoods - Brightwood and North End - of Springfield and for its architecture. It contains work of two nationally prominent architects and several of Springfield's top architects of the turn of the century. Notable structures include the Trolley Barn, the branch public library, and the Memorial Church.

Until the latter part of the nineteenth century, Memorial Square was primarily defined by a north-south drumlin known as Round Hill. Roads leading north from Springfield split just south of the hill, with the eastern branch (North Main Street) continuing the path of Main Street to Chicopee, and the western branch (Plainfield Street) swinging westerly through the broadened flood plain of the Connecticut River to the river's banks and then northerly to Chicopee. After the Civil War, Round Hill began to be developed into three large estates for prominent city families. The area just south of the Square was also built up during this period, but with less affluence. A physical link was established with downtown through a green space, numbering the length of the middle of Main Street. This terrace, approximately twenty-five feet wide, and having a central row of trees, began at Memorial Square. In 1877 the North End Bridge was constructed where Plainfield Street first approaches the river bank, thus linking the developing northern district of Springfield with West Springfield.

The religious society which later became affiliated with the Memorial Church (#1) was organized in 1865 through the efforts of Christian laymen, principally, George Atwater and Dr. J. G. Holland. Mr. Atwater, who has a seven hundred acre estate at the northern edge of town, was the head of the Springfield Street Railway, and owner of the Glasgow Mills in Ludlow. He later wrote that during the '60's, as this section of town was developing, he noticed that no provision was being made for a church and, concerned for the spiritual welfare of these citizens, began organizing for one. He donated \$18,000 and a large amount of his time to these efforts. His neighbor and good friend, Dr. Holland, was a leading member of the town's literati. He was associate editor of the Springfield Republican, a nationally respected newspaper at this time, and a well-published poet, novelist and historian. A Sunday School formed in 1865 had Dr. Holland as its superintendent. The religious society was formed as a Union Evangelical Church and when the church was built it was dedicated to the memory of the deceased ministers of New England. These ministers, as well as George Atwater, are memorialized in the Tiffany stained glass windows.

UNITED STATES DEPARTMENT OF THE INTERIOR
NATIONAL PARK SERVICE

FOR NPS USE ONLY
RECEIVED
DATE ENTERED

**NATIONAL REGISTER OF HISTORIC PLACES
INVENTORY -- NOMINATION FORM**

CONTINUATION SHEET

ITEM NUMBER

PAGE

Memorial Square District

8

1

This church was the first of five started in the city during the building boom following the Civil War. Springfield, because of the presence of the U. S. Armory, had prospered during the war, and this prosperity was now made visible. Mr. Atwater acquired the services of Richard Upjohn, the renowned Gothic revival architect of the middle nineteenth century, for Memorial Church. Upjohn was devoting most of his time to the functionings of the American Institute of Architects, which he had helped found in 1857. More and more of the commissions he received in these years were being given only cursory attention. This was due in part to the active part played by R. M. Upjohn, the elder Upjohn's son, who became associated with his father in 1858 and dominated the firm in the years following the Civil War. Obvious Victorian additions, representing the son's influence, are the striped slate of the roof and the banded arches of the entranceways. Nonetheless, Richard Upjohn considered this an important commission and is known to have worked on the design himself. In fact, this is considered his last completed ecclesiastical building. The firm used local carpenters, but the masons, Ponsonby and Maginn, were from New York. These masons were to work on H. H. Richardson's first commission, the Church of the Unity, in Springfield during the same period.

The Memorial Square Library's (#2) principal architect, Edward Tilton, is also connected with other public buildings in the city. In 1908 he won the design competition for the present City Library, and during the early 1930's designed the Museum of Fine Arts and the extensive addition to the Museum of Natural History which completed the city's cultural area known as the Quadrangle. All of these buildings are in the Quadrangle-Mattoon Street National Register District.

Tilton trained with the firm of McKim, Mead and White and attended the Ecole des Beaux Arts in Paris. He was particularly involved in library design throughout his career which spanned four decades beginning in 1890, and his work extends through most of eastern United States. His is listed as one of the founders of the National Beaux Arts Society of Architects.

The Street Railway Company's (#5) designer, Eugene C. Gardner, the senior partner of Gardner, Pyne and Gardner was Springfield's best known and most influential architect during the late nineteenth and early twentieth centuries. He has been referred to as "one of the last of the important pattern book authors" and again "that antistylistic, utilitarian pattern of thought which had been a product of

UNITED STATES DEPARTMENT OF THE INTERIOR
NATIONAL PARK SERVICE

FOR NPS USE ONLY

RECEIVED

DATE ENTERED

NATIONAL REGISTER OF HISTORIC PLACES
INVENTORY -- NOMINATION FORM

CONTINUATION SHEET

ITEM NUMBER

PAGE

Memorial Square District

8

2

mid-century romantic rationalism and which reached its middle 70's peak in E. C. Gardner". No other single architect contributed as much in bringing Springfield into the twentieth century. His career spanned half a century, from the 1860's until the second decade of the twentieth century, all but the first four or five years in this city.

Gardner's early training had been as a mason and school teacher, both of which are well illustrated in his later career. He is first listed as an architect in Florence, Massachusetts (a village of the city of Northampton) in 1865.

The Memorial Church Parish House (#7) architect, Francis R. Richmond, began his building career as a carpenter in the Amherst area. In the early 1870's he came to Springfield and worked under E. C. Gardner until 1882. In that year he formed a partnership with B. Hammett Seabury, a recent graduate of Boston Tech. During their partnership their designs incorporated many elements from Queen Anne and Romanesque styling. This partnership lasted until 1890.

Melzar H. Mosman worked for the Ames Sword Manufacturing Company in Chicopee for seventeen years. This experience aided him in starting his own career as a sculptor and foundry man. He considered the Spanish-American War Memorial (#3) his finest work. He also designed the GAR Memorial in Court Square.

R. Hale Smith (#8) was a local industrialist and inventor. At his death his "business...practically the largest of its kind in the world, and the products are shipped to all parts of the globe". He was the inventor of the "motometer", a device which determined the speed of autos and the distance traveled. He was active in local politics as a member of City Council and of the Board of Public Works. After Mr. Smith died in 1908 the house was occupied by Dr. Seth A. Lewis for fifty years. He practiced medicine in Springfield for sixty-three years and was the physician for the Street Railway Company for over thirty years. Edgar Sweatland (#9) was in the whip manufacturing business in Westfield.

The turn of the century was Springfield's major period of growth and development. The Street Railway Company (#5) was very instrumental in this growth. The Street Railway's Main and Carew Street Building is a direct result of this growth, as the late 1890's were the peak period for this company. The Street Railway Company sold the structure in 1958 to a locally based interstate bus company which used it as a garage until the early 1970's. It is now being leased for automotive repair.

UNITED STATES DEPARTMENT OF THE INTERIOR
NATIONAL PARK SERVICE

**NATIONAL REGISTER OF HISTORIC PLACES
INVENTORY -- NOMINATION FORM**

FOR NPS USE ONLY

RECEIVED

DATE ENTERED

CONTINUATION SHEET

ITEM NUMBER

PAGE

Memorial Square District

8

3

During the same time period a pressing need for a library was felt. The North End was Springfield's immigrant center throughout the nineteenth century as each successive group made their first stop here. This development was at its peak at the beginning of the twentieth century. The resulting Memorial Square Library (#2) was second only to the central library in size and scope. It served the neighborhood as a public facility for over fifty years.

Memorial Church (#1) and Parish House (#7) were sold to the Greek Orthodox Church in the late 1930's. Both structures have been owned by this religious group since then. The two residences (#8 & #9) were bought by the North End Drug Abuse Program in the early 1970's and are presently being used by them.

9 MAJOR BIBLIOGRAPHICAL REFERENCES

- Upjohn, E., Richard Upjohn Architect and Churchman, 1939.
 Hitchcock, Henry Russell, Catalogue of an Exhibition of Photographs Illustrating
 Springfield Architecture 1800-1900, 1934.
Historical Sketches and Brief Accounts of Clubs, Societies, Organizations, etc.
 for Springfield's 275th Anniversary, 1911
Biographical Dictionary of American Architects (Deceased), Henry F. and Elsie
 Rathbun Withey, 1956

10 GEOGRAPHICAL DATA

ACREAGE OF NOMINATED PROPERTY Approx. 6½ acres

UTM REFERENCES

A	118	6981180	4664710	B	118	6983000	4664600
	ZONE	EASTING	NORTHING		ZONE	EASTING	NORTHING
C	118	6982100	4664480	D	118	6981200	4664520

VERBAL BOUNDARY DESCRIPTION

Beginning at the southern corner of the district, continuing northeast along Sargeant St., crossing Main St. and continuing northeast on Carew St. to the northeast property line of property #5; continuing northwest along the rear property line of #5 to the northwest property line of property #5; continuing southwest along this line to the Passageway; continuing northwest along Passageway, across Church Street and along the rear property lines of properties #8 and #9 to the northwest property line of property #9; continuing southwest along the property line of property #9 (CONT.)

LIST ALL STATES AND COUNTIES FOR PROPERTIES OVERLAPPING STATE OR COUNTY BOUNDARIES

STATE	CODE	COUNTY	CODE
STATE	CODE	COUNTY	CODE

11 FORM PREPARED BY

NAME / TITLE	(Edmund Lonergan, Springfield Historical Commission) Blaine Mallory and Joseph Orfant, National Register Editor	
ORGANIZATION	Massachusetts Historical Commission	DATE May 3, 1977
STREET & NUMBER	294 Washington Street	TELEPHONE 617-727-8470
CITY OR TOWN	Boston	STATE Massachusetts, 02108

12 STATE HISTORIC PRESERVATION OFFICER CERTIFICATION

THE EVALUATED SIGNIFICANCE OF THIS PROPERTY WITHIN THE STATE IS:

NATIONAL STATE LOCAL

As the designated State Historic Preservation Officer for the National Historic Preservation Act of 1966 (Public Law 89-665), I hereby nominate this property for inclusion in the National Register and certify that it has been evaluated according to the criteria and procedures set forth by the National Park Service.

STATE HISTORIC PRESERVATION OFFICER SIGNATURE

Elizabeth Reed Amadon

TITLE

Executive Director, Mass. Historical Commission DATE 5/31/77

FOR NPS USE ONLY

I HEREBY CERTIFY THAT THIS PROPERTY IS INCLUDED IN THE NATIONAL REGISTER

DATE

DIRECTOR, OFFICE OF ARCHEOLOGY AND HISTORIC PRESERVATION
 ATTEST:

DATE

KEEPER OF THE NATIONAL REGISTER

UNITED STATES DEPARTMENT OF THE INTERIOR
NATIONAL PARK SERVICE

FOR NPS USE ONLY

RECEIVED

DATE ENTERED

**NATIONAL REGISTER OF HISTORIC PLACES
INVENTORY -- NOMINATION FORM**

CONTINUATION SHEET

ITEM NUMBER 10 PAGE 1

Verbal Boundary Description:

across Main Street and along northwest property line of property #1 to Plainfield St.; continuing southeast along Plainfield Street to Bradford Street; continuing southwest along Bradford Street to the southwest property line of property #2; continuing southeast along this line to starting point.

UNITED STATES DEPARTMENT OF THE INTERIOR
NATIONAL PARK SERVICE

FOR NPS USE ONLY

RECEIVED

DATE ENTERED

NATIONAL REGISTER OF HISTORIC PLACES INVENTORY -- NOMINATION FORM

CONTINUATION SHEET

ITEM NUMBER 10 PAGE 2

UTM References:

E 18/698 180/4664 580

F 18/698 080/4664 600

UNITED STATES DEPARTMENT OF THE INTERIOR
NATIONAL PARK SERVICE

FOR NPS USE ONLY

RECEIVED

DATE ENTERED

**NATIONAL REGISTER OF HISTORIC PLACES
INVENTORY -- NOMINATION FORM**

CONTINUATION SHEET

ITEM NUMBER 4 PAGE 1

Key to Sketch Map, and Property Owners:

Building:

1- Memorial Church
2310 Main Street
Springfield, Mass. 01103

2- Memorial Square Library
Main Street
Springfield, Mass. 01103

3&4- Park and Memorial Square
Main Street
Springfield, Mass.

5- Springfield Street Railway
Building (Trolley Barn)
2257-73 Main Street
Springfield, Mass. 01103

6- Memorial Square Building
2291-95 Main Street
Springfield, Mass. 01103

7- Memorial Church Parish Hall
2309 Main Street
Springfield, Mass. 01103

8-Smith House
2335 Main Street
Springfield, Mass. 01103

9- Sweatland House
2345 Main Street
Springfield, Mass. 01103

Owner:

St. George Orthodox Greek Church
2309 Main Street
Springfield

City of Springfield
City Hall
Springfield

City of Springfield
City Hall
Springfield

Peter Picknelly
c/o Peter Pan Bus Lines
1776 Main Street
Springfield

Abel and Virginia Gomes
171 Grattan Street
Chicopee Falls, Mass. 01013

St. George Orthodox Greek Church
2309 Main Street
Springfield

Drug Abuse Foundation of Pioneer
Valley, Inc.
2345 Main Street
Springfield

Same as #8

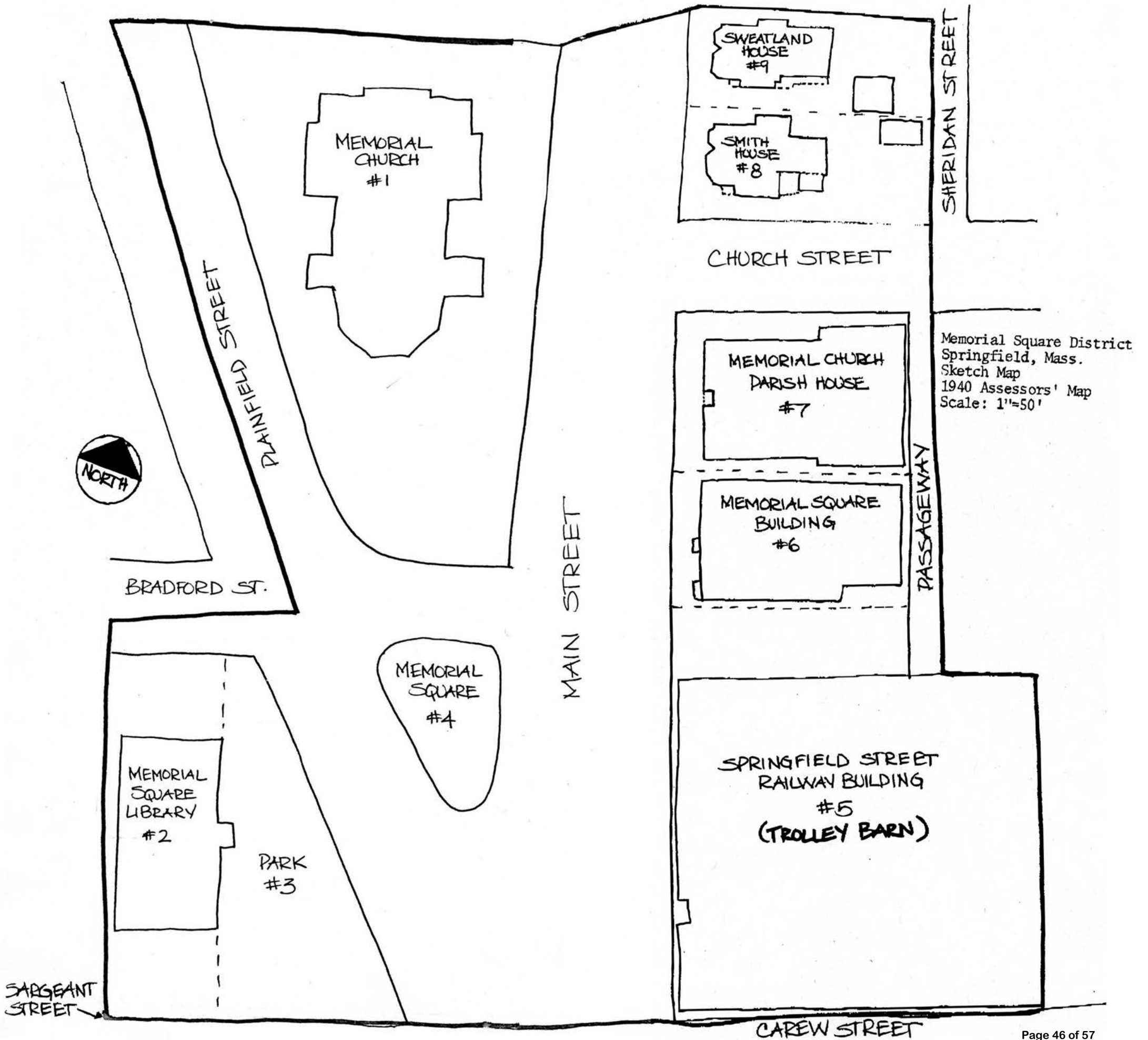

Memorial Square District
 Springfield, Mass.
 Sketch Map
 1940 Assessors' Map
 Scale: 1"=50'

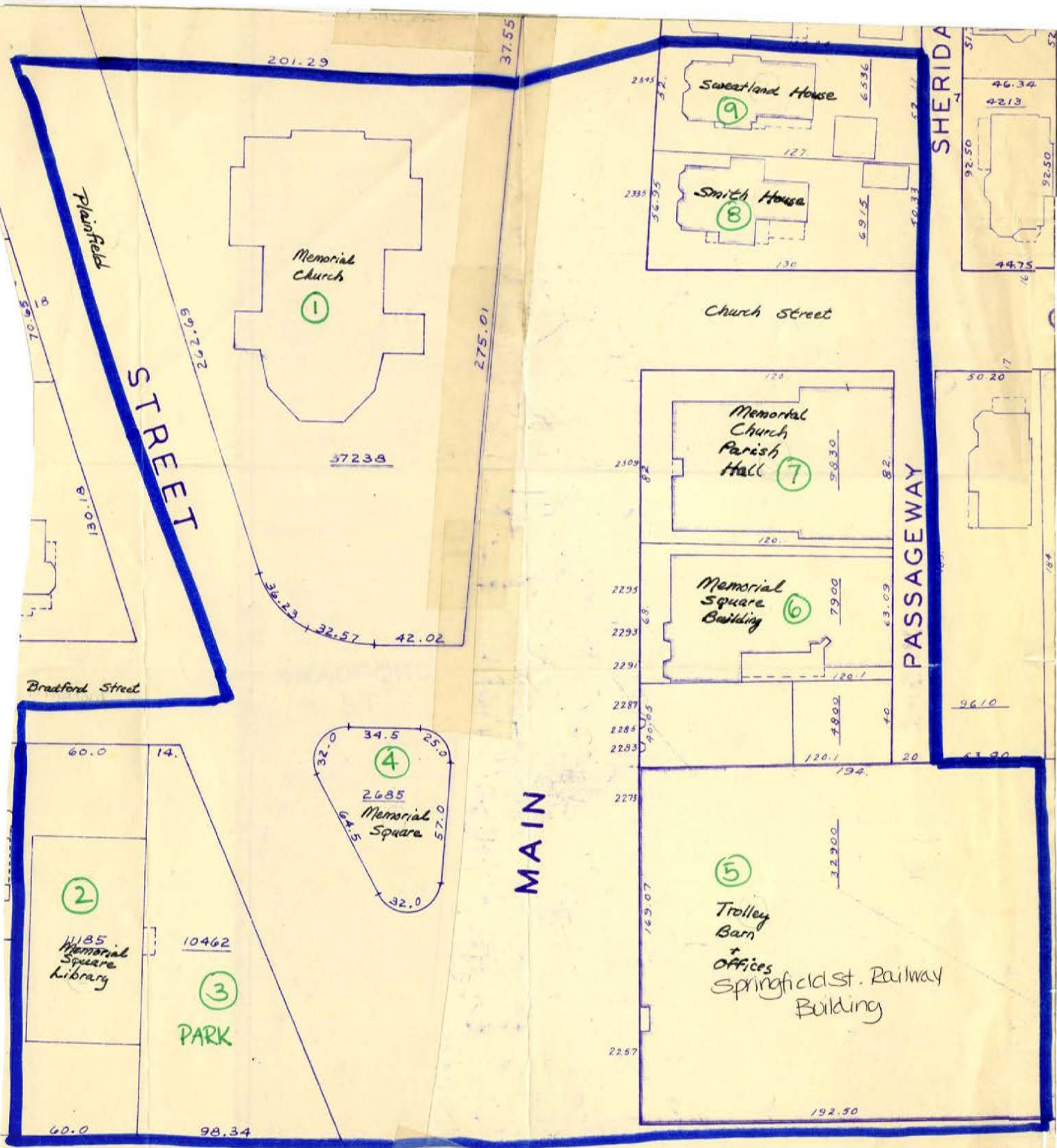

Proposed Memorial Square
 National Register District
 Springfield, Massachusetts



UNITED STATES
DEPARTMENT OF THE INTERIOR
GEOLOGICAL SURVEY

STATE OF MASSACHUSETTS
DEPARTMENT OF LAND AND NATURAL RESOURCES

6463 11 NW
(MOUNT TOM)

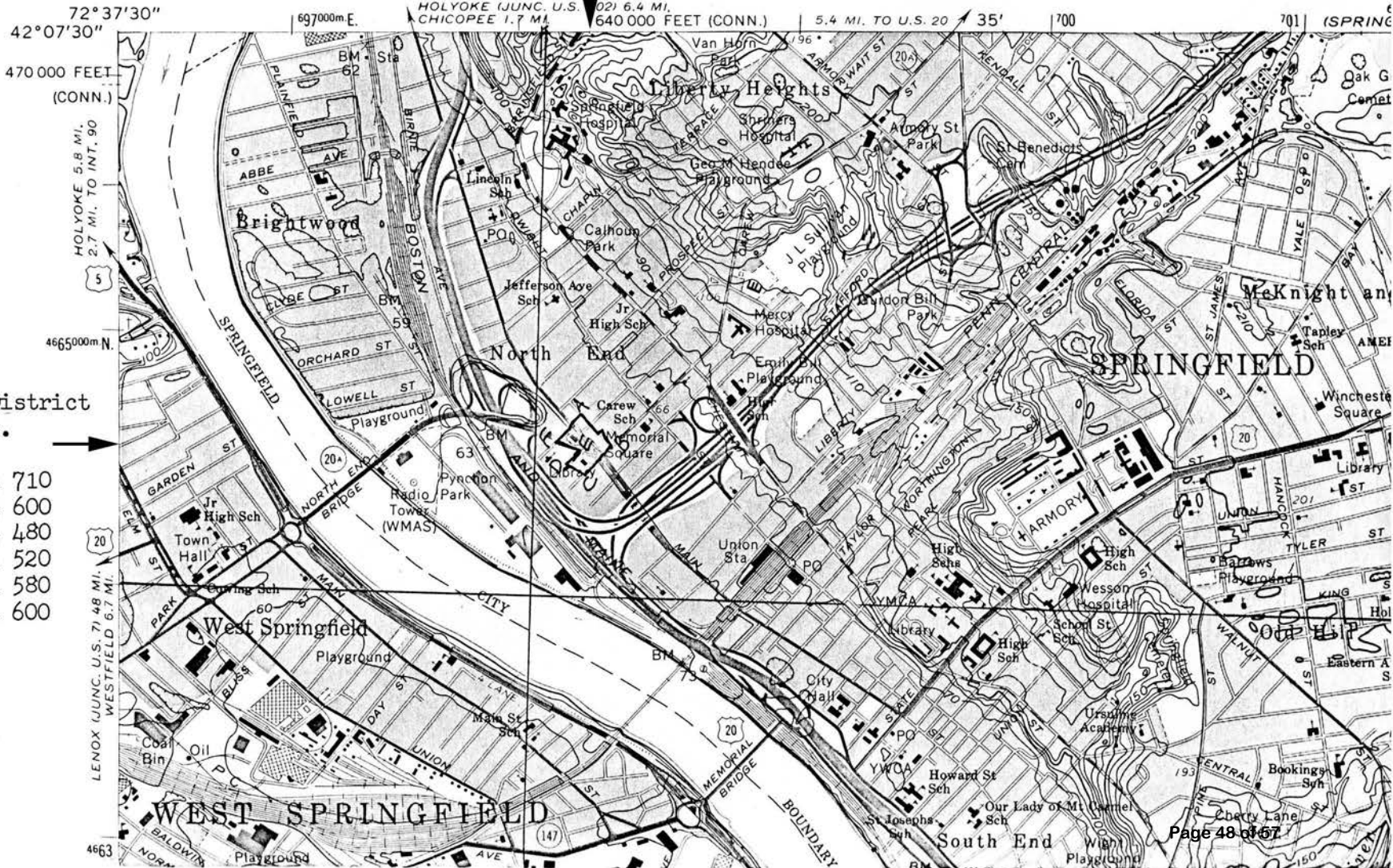

Memorial Square District
Springfield, Mass.

UTM Coordinates:

- A 18/698 180/4664 710
- B 18/698 300/4664 600
- C 18/698 200/4664 480
- D 18/698 120/4664 520
- E 18/698 180/4664 580
- F 18/698 080/4664 600



1. View of Memorial Square from the south. (Photograph: Kathleen Morehead, 1976)





SECOND
MASSACHUSETTS
INFANTRY U.S.V.
WAR WITH SPAIN 1898

ERECTED BY FRIENDS
OF THE REGIMENT IN
EVERLASTING REMEMBRANCE

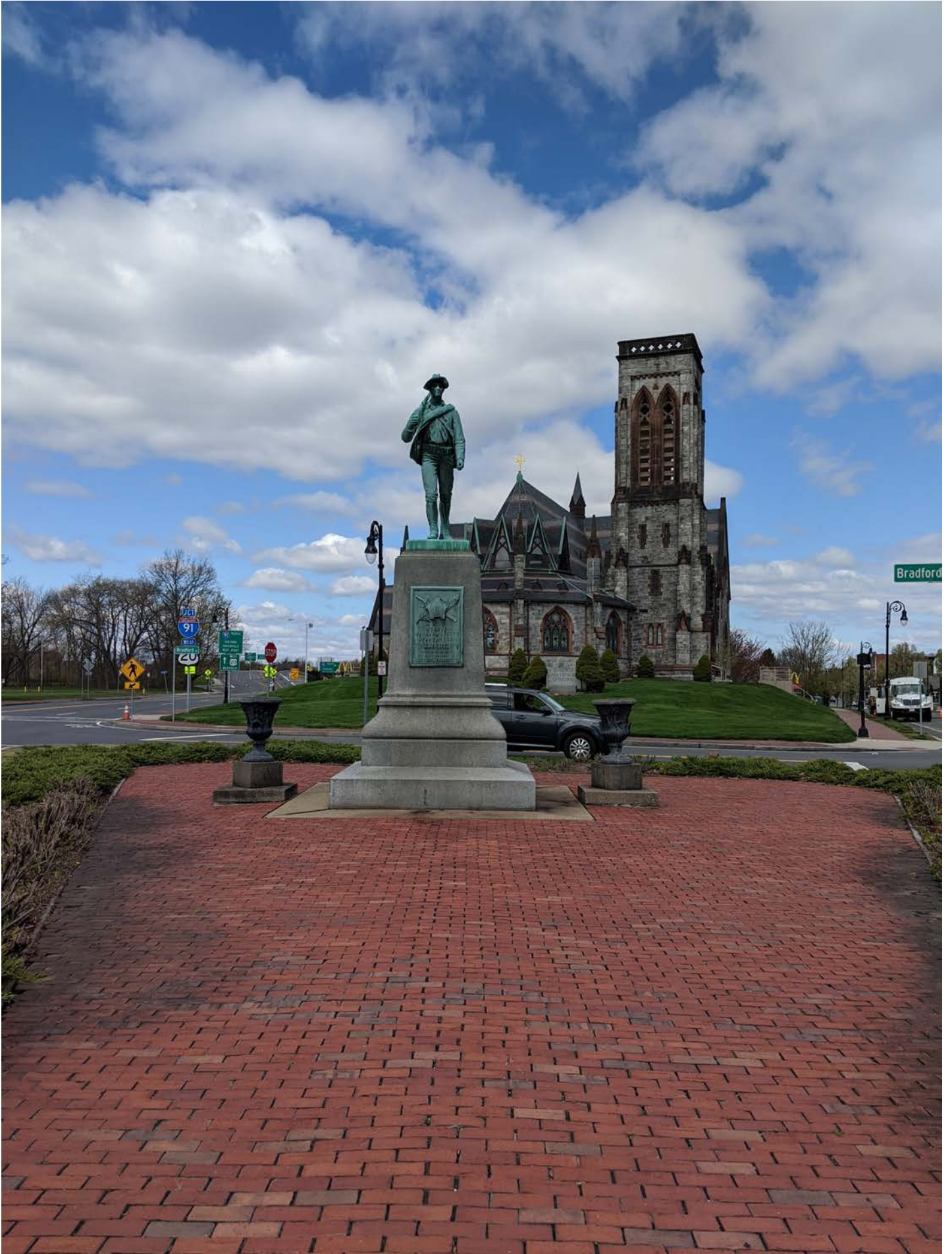





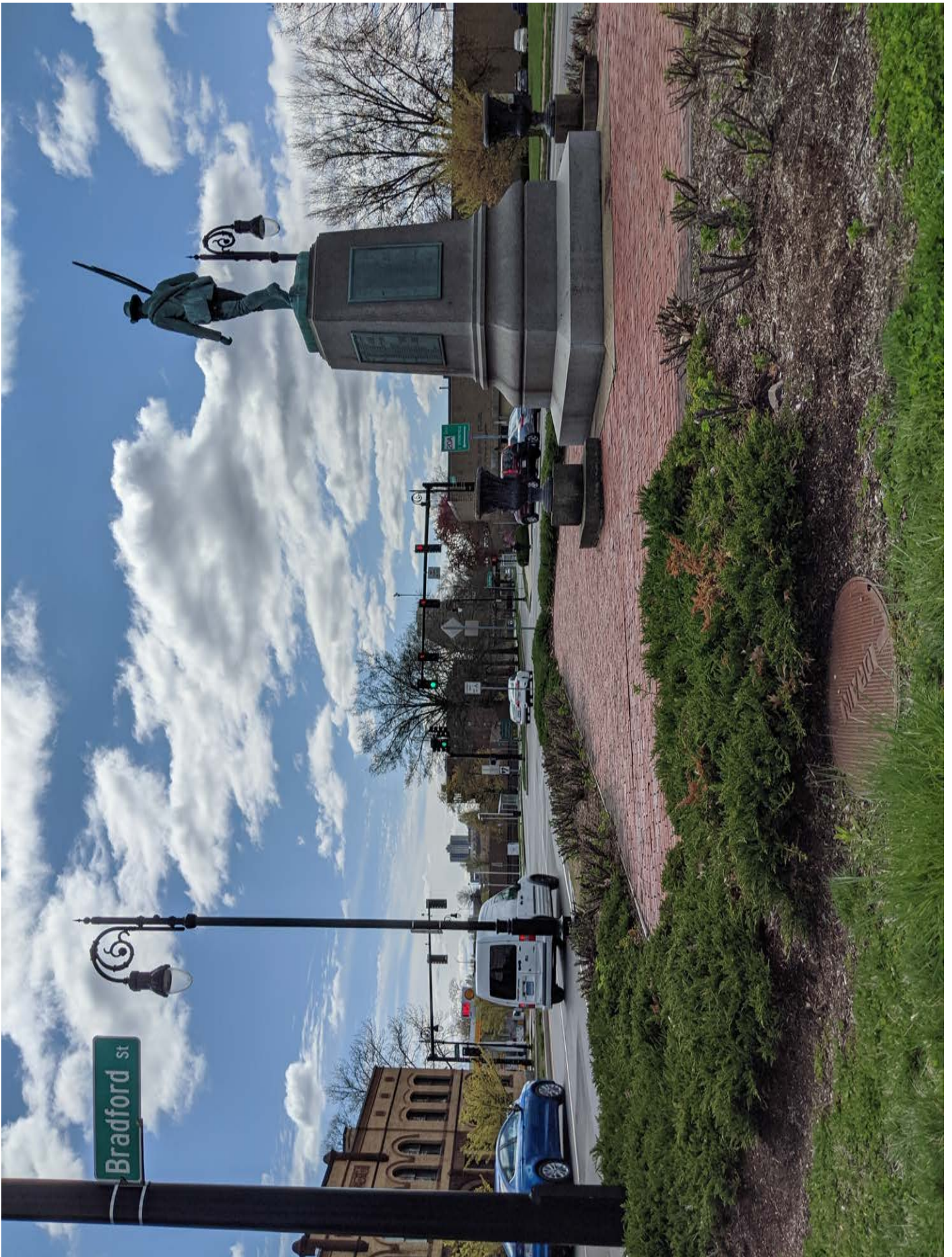



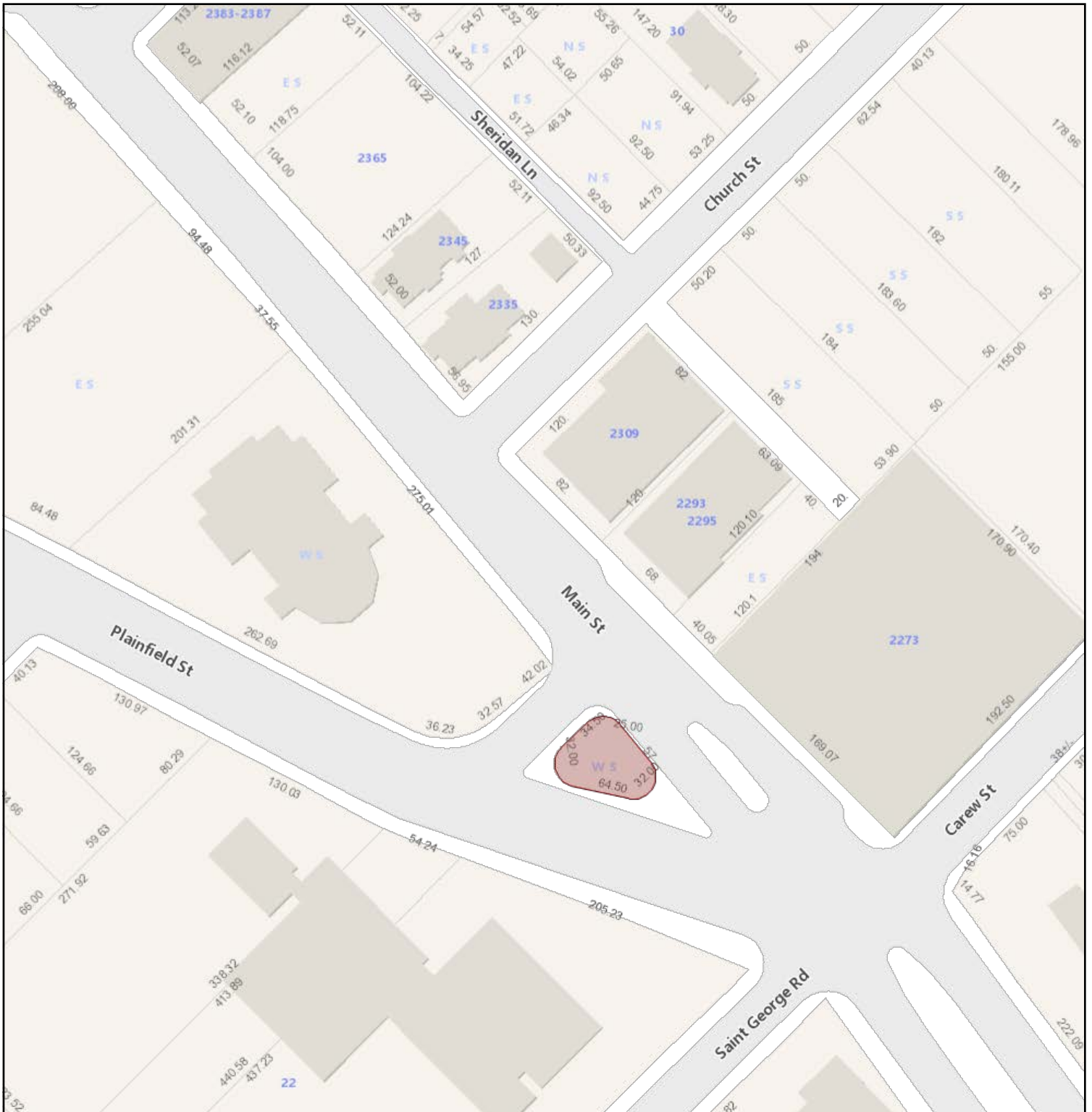

W S MAIN ST

4/10/2020 11:18:33

1"=94'

Property Information

Parcel ID	08130-0212
Owner Name	SPRINGFIELD CITY OF
Owner Address1	
Owner Address2	SPRINGFIELD, MA
Land Area In Square Feet	2,685
Assessed Value	600
Historic	NRD
Zoning Name	Business A



GIS information is provided on these Web Pages as a public resource for general information purposes only. It is used to locate, identify and inventory parcels of land in the City of Springfield for general purposes only and is NOT to be construed or used as a "legal description." Map and parcel information is believed to be accurate but accuracy is not guaranteed. No portion of the information should be considered to be, or used as, a legal document. The information is provided subject to the express condition that the user knowingly waives any and all claims for damages against the City of Springfield that may arise from the use of this data. Information provided on these Web Pages should be verified with the appropriate City department, and reviewed and approved by an attorney or other qualified professional prior to its use for any purpose with potential legal consequences.

